

RECOMMENDED MOUNTING

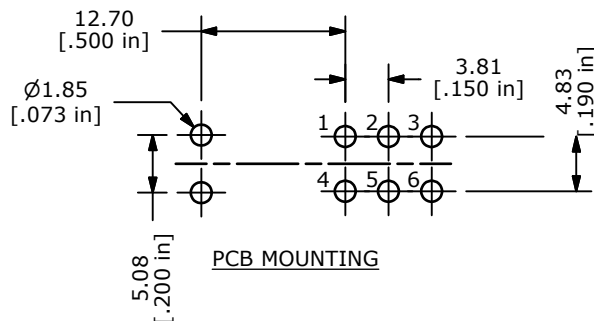
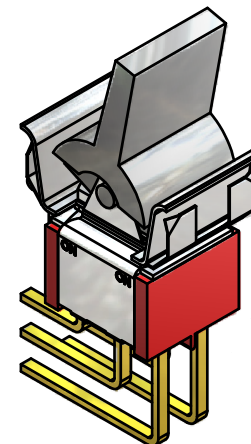
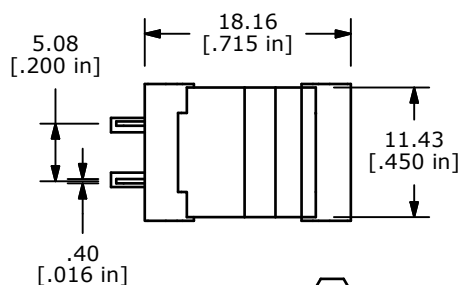
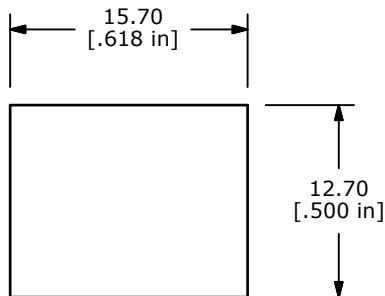

PCB MOUNTING

NOTE:

1. ALL DIMENSIONS IN MM [INCH]
2. GENERAL TOLERANCE: X.X=±0.4  
X.XX=±0.25
3. TERMINAL NUMBERS FOR REF ONLY
- ▲ 4. PLATING MATERIAL: SILVER
5. CONTACT RESISTANCE: 10 MEGA OHM MAX @2-4VDC 100mA
6. LIFE EXPECTANCY: 40,000 MAKE-AND-BREAK CYCLES AT FULL LOAD.
7. PANEL THICKNESS: 1.19 - 3.18 mm
8. INSULATION RESISTANCE: 1,000 MEGA-OHM MIN.
9. DIELECTRIC STRENGTH: 1,000 V RMS @SEA LEVEL.
10. OPERATING TEMP.: -30°C to 85°C
11. CONTACT RATING: 5 AMPS @ 120 VAC OR 28VDC 2 AMPS @ 250 VAC
11. ▲ DENOTES CRITICAL PARAMETER.
12. 2002/95/EC (ROHS) COMPLIANT.

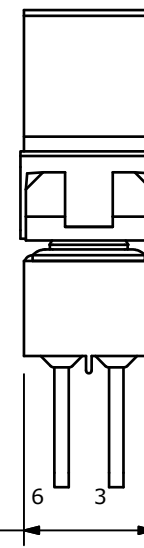
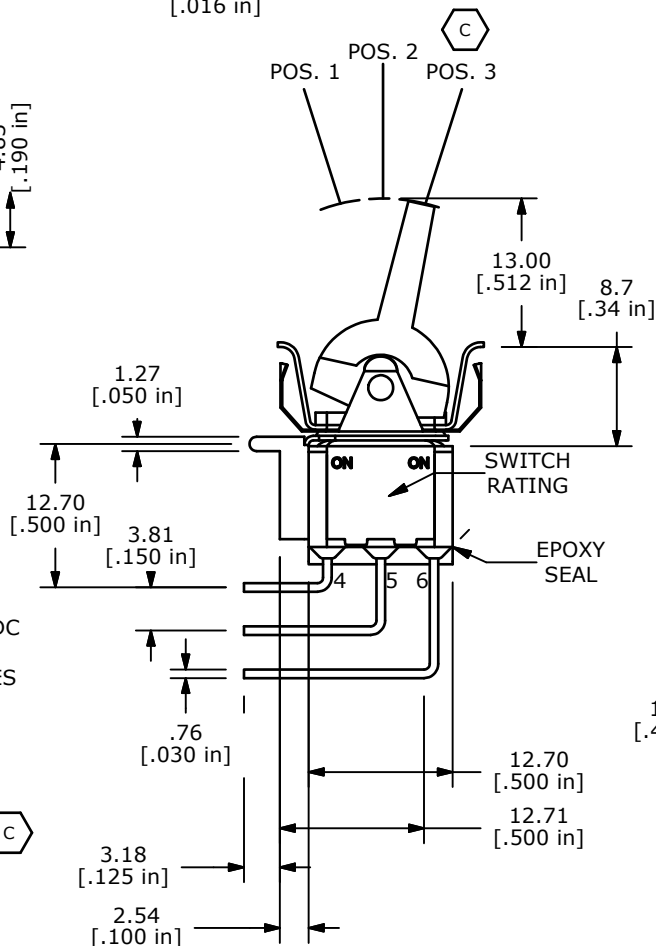

SWITCH FUNCTION		
POS. 1	POS. 2	POS. 3
ON	NONE	ON
2-3, 5-6	N/A	2-1, 5-4

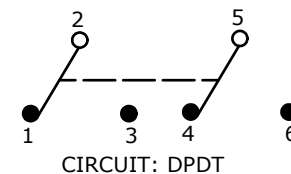

C	19846	ADD RATING AND POSITIONS	04/14/11	BMA
B	19680	CORRECT SWITCH FUNCTION	02/15/11	BMA
A	19675	RELEASED FOR PRODUCTION	02/14/11	BMA
REV	PCR NO	DESCRIPTION	DATE	BY

THE INFORMATION CONTAINED IN THIS DOCUMENT IS PROPRIETARY TO E-SWITCH AND IS NOT TO BE COPIED OR TRANSFERRED



TITLE 300DP1R8BLKM7QE

SCALE	DATE	DR	DWG	REV
2:1	2/14/2011	BMA	T324077	C