

SPECIFICATIONS

FUNCTION:

1P1T OFF-(ON) + 1P1T ON-(OFF)

RATINGS:

ANSI/UL 61058-1 and CAN/CSA C22.2 No. 61058-1 (E333880):
18(18)A 250V~ RM T55 [cURus]

EN 61058-1:2002 (50174439):
18(18)A 250V~ SE4 T55 [TÜV]

OPERATING FORCE:

6.1bf±1.1bf [3.0kgf±0.5kgf]

ELECTRICAL LIFE:

6,000 Cycles [cURus: 30°C Rise]
50,000 Cycles [TÜV, cURus: 55°C Rise]

TEMPERATURE:

Operating: 0°C to 55°C [cURus, TÜV]

APPROVALS:

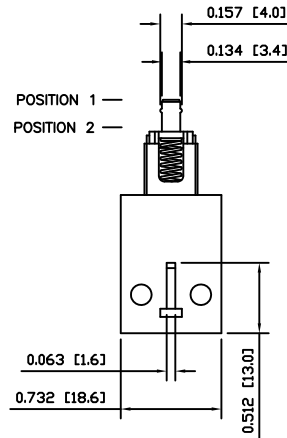
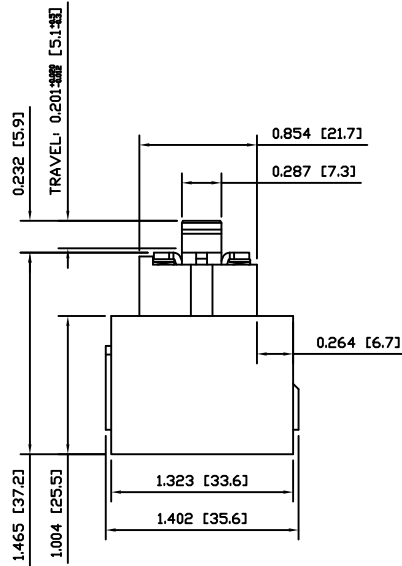
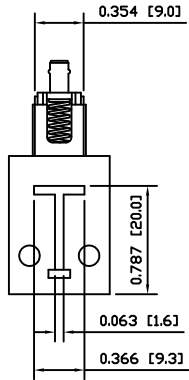
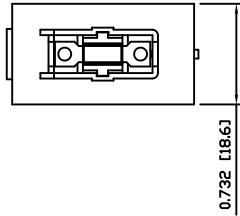

COLORS

BODY:
White

ACTUATOR:
Black

LOCK:
None

SCHEMATIC

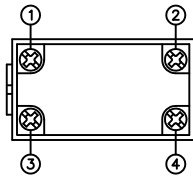
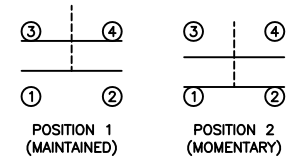

THE INFORMATION CONTAINED IN THIS DOCUMENT IS PROPRIETARY TO E-SWITCH AND IS NOT TO BE COPIED OR TRANSFERRED

REV.	DESCRIPTION	DATE	BY
D	CHANGED SCREWS TO PHILLIPS/FLAT	19210	10/07/22 CAB
C	ADDED TÜV APPROVAL, CORRECTED GENERAL TOLERANCE	18863	10/02/12 CAB
B	CORRECTED SCHEMATIC NUMBERS	PCRD0239	09/12/08 CAB
A	INITIAL RELEASE	PCRD0168	09/10/14 CAB
		PCR	DATE DRAWN BY

DIMENSIONS	
INCHES [MILLIMETERS]	
GENERAL TOLERANCES	
0.000~0.236: ±0.004 [0~6: ±0.1]	
0.236~1.181: ±0.012 [6~30: ±0.3]	
1.181~4.724: ±0.020 [30~120: ±0.5]	
SCALE	DRAWING NOT TO SCALE

TITLE	
HY106-6Y7-000-0000	
PROJECTION	ITEM NUMBER
	34-HY1066Y70000000
DATE	REVISION
JULY 22, 2010	D