

SWITCH FUNCTION		
POS. 1	POS. 2	POS. 3
ON	NONE	ON
2-3	OPEN	2-1

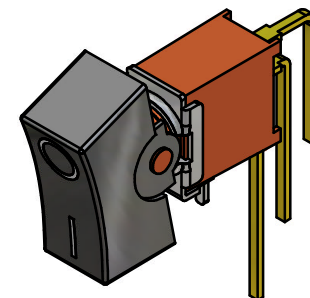

ISOMETRIC

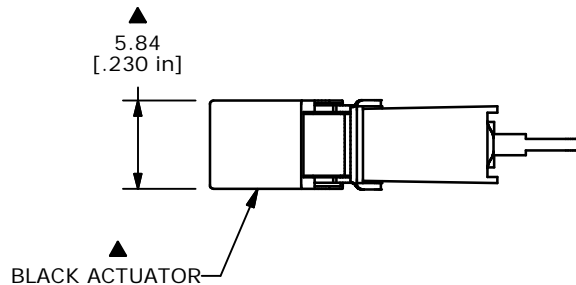
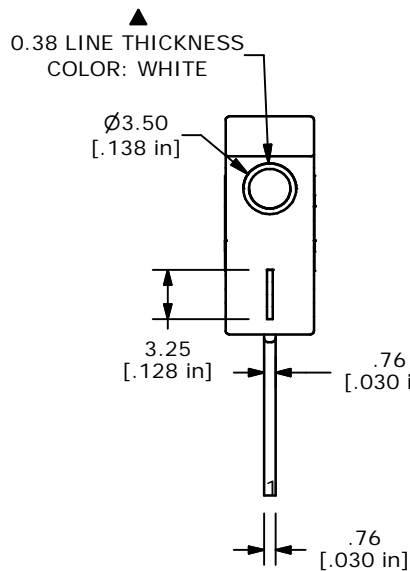
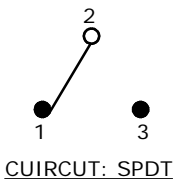
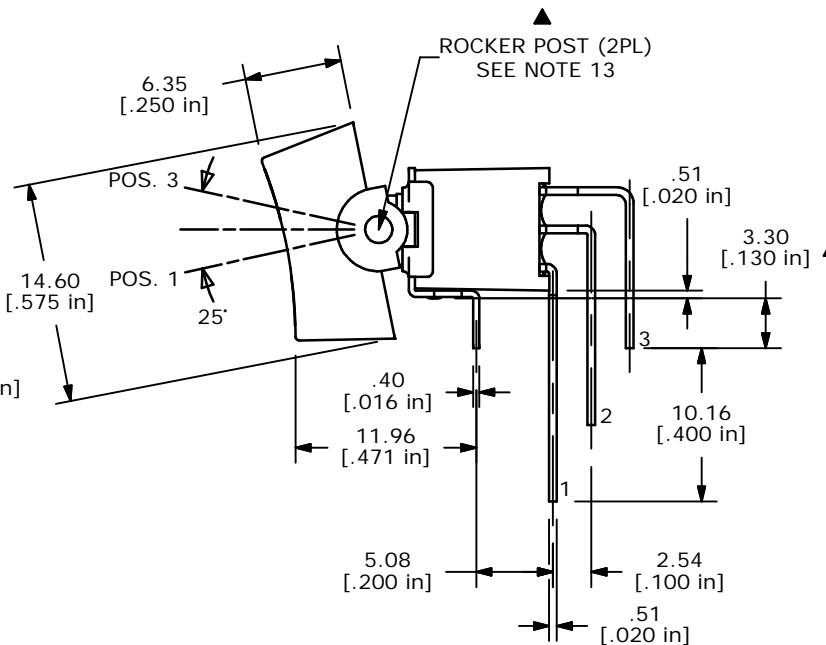

- NOTE:
- ALL DIMENSIONS IN MM [INCH]
 - GENERAL TOLERANCE: X.X=±0.4
X.XX=±0.25
 - TERMINAL NUMBERS FOR REF ONLY
 - PLATING MATERIAL: GOLD
 - PLASTIC MATERIAL: HOUSING: UL-94-V0
ROCKER: UL-94-V0
 - WHITE MARKING AS SHOWN ON BLACK ROCKER.
 - DATE CODE: OPPOSITE SIDE OF LOGO:
YEAR NAD WEEK (EG. 0143=43 WEEK 2001)
 - RATING: 0.4VOLT-AMPS MAX. @20V MAX. AC OR DC
 - ELECTRIC LIFE: 30,000 MAKE-AND-BREAK CYCLES
AT FULL LOAD.
 - INSULATION RESISTANCE: 1,000 MEGA-OHM MIN.
 - DIELECTRIC STRENGTH: 1,000 V RMS @SEA LEVEL.
 - OPERATING TEMP.: -30°C to 85°C
 - EXTEND ROCKER POST TO 0.63 (WAS 0.45)
AND REMOVE CHAMFER. (2 PL)
 - ▲ DENOTES CRITICAL PARAMETER.

E-SWITCH®

TITLE 400AWMSP1R6BLKM7RE I/O MARKING

B	14685	REVISED AND REDRAWN	2/11/05	AR
REV	PCR NO	DESCRIPTION	DATE	BY

THE INFORMATION CONTAINED IN THIS DOCUMENT IS PROPRIETARY TO E-SWITCH AND IS NOT TO BE COPIED OR TRANSFERRED

SCALE	DATE	DR	DWG	REV
2:1	2/11/05	AR	T403013	B