

CIRCUIT

▲ 1 POSITION

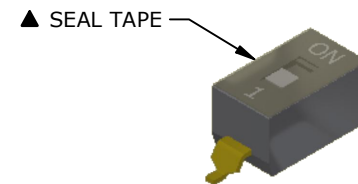
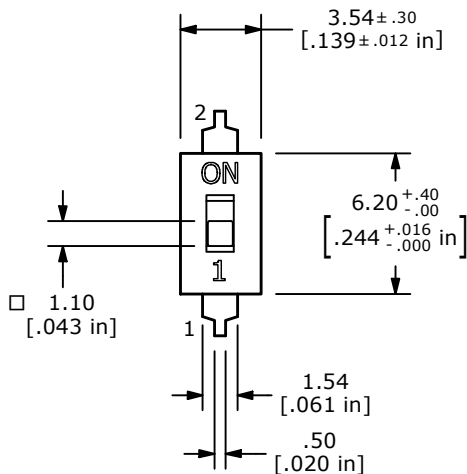

NOTES:

1. ALL DIMENSIONS IN MM [INCH].
2. GENERAL TOLERANCE: X.X = ±0.4
X.XX = ±0.25
3. TERM. NOS. FOR REFERENCE ONLY
4. CONTACT RATINGS: 25mA @24VDC (SWITCH)
100mA @50VDC (CARRY)
- ▲ 5. CONTACT/TERMINALS: GOLD PLATED
6. INSULATION RESISTANCE: 100 MΩ MIN. @500VDC
7. CONTACT RESISTANCE: 50 mΩ MAX INITIAL
8. OPERATING TEMP: -40°C to +85°C
9. STORAGE TEMP: -40°C to +85°C
10. ELECTRICAL LIFE: 1000 CYCLES @ 25mA, 24VDC
11. MECHANICAL LIFE: 1000 CYCLES
12. TRAVEL: 0.9mm
13. ▲ DENOTES CRITICAL PARAMETER.
14. DIELECTRIC STRENGTH: 500VAC MIN FOR 1 MINUTE
15. OPERATING FORCE: 1000gf MAX.
- ▲ 16. PACKAGE: TAPE AND REEL: 1,300 pcs/REEL
WITH ALL POLES IN THE "OFF" POSITION

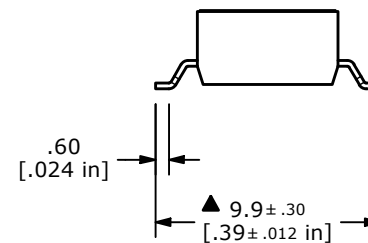
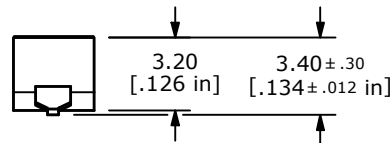

REV	ECO NO	DESCRIPTION	DATE	BY
C	ECO-102601	print update	03/29/24	MW

			OBJECT ID
			100124926
TITLE KAG01TGGR			

SCALE 3:1	DATE 6/12/2023	DR JS	DWG P800001	REV C
--------------	-------------------	----------	----------------	----------