

## NOTES:

1. ALL DIMENSIONS IN MM [INCH]
2. GENERAL TOLERANCE: X.X =  $\pm 0.4$   
X.XX =  $\pm 0.25$
3. TERMINAL NUMBERS FOR REF ONLY
4. CONTACT RATING: CURRENT: 100mA  
VOLTAGE: 30 VDC
5. OPERATING LIFE: 50,000 MAKE-AND-BREAK CYCLES
6. INSULATION RESISTANCE: 500VDC, 100M $\Omega$  MIN.
7. OPERATING FORCE: 250gf  $\pm 100$ gf
8. OPERATING TEMP.: -40°C to 70°C
- ▲ 9. TRAVEL: 0.7  $\pm 0.3$ mm LOCK  
1.80  $\pm 0.3$ mm FULL TRAVEL
10. CONTACT RESISTANCE: 50m $\Omega$  MAX.
11. ▲ DENOTES CRITICAL PARAMETER.
- ▲ 12. LED COLOR: RED

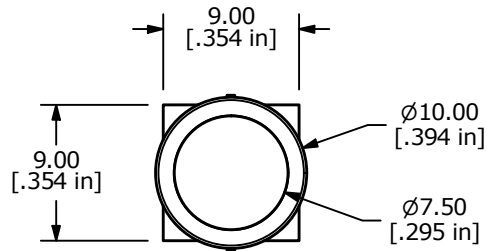

▲ TRANSPARENT CAP  
with RED LED

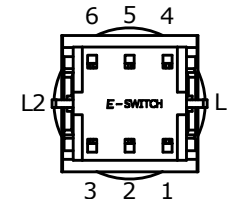
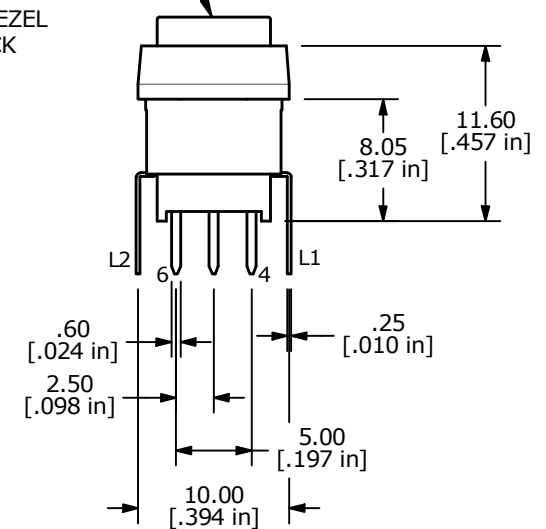
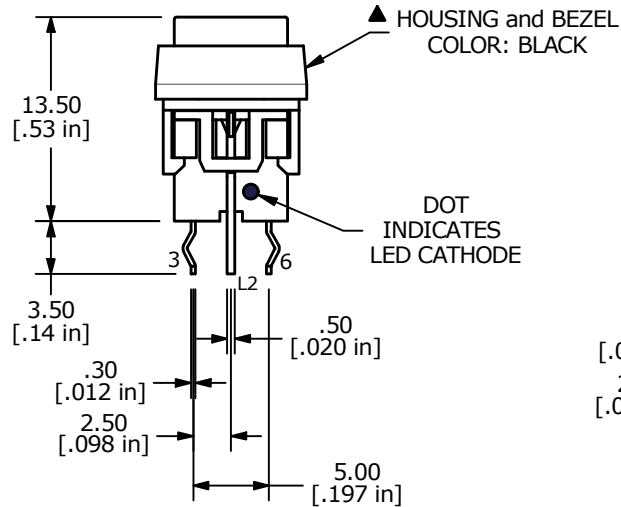

LED SPECS	UNITS	RED
FORWARD CURRENT	mA	20
FORWARD VOLTAGE	V	1.9-2.5
LUMINOUS INTENSITY	MCD	200

REV	ECO NO	DESCRIPTION	DATE	BY
B	ECO-101059	Release	06/17/22	MW



E-SWITCH®

OBJECT ID  
000006707

TITLE  
LP4EE1PBBTR

SCALE  
2:1

DATE  
5/31/2013

DR  
EBP

DWG  
B240047

REV  
B

THE INFORMATION CONTAINED IN THIS DOCUMENT IS PROPRIETARY TO  
E-SWITCH AND IS NOT TO BE COPIED OR TRANSFERRED