

NOTES:

1. ALL DIMENSIONS IN MM [INCH]
2. GENERAL TOLERANCE: X.X = ± 0.4
X.XX = ± 0.25
3. TERMINAL NUMBERS FOR REF. ONLY
- ▲ 4. RATING: 30mA @ 28VDC
5. TRAVEL: ELECTRICAL MAKE: $11.0 \pm 0.2\text{mm}$
FULL TRAVEL: $2.0 \pm 0.30\text{mm}$
6. OPERATING FORCE: $430 \pm 102\text{gf}$
7. ELECTRICAL LIFE: 20,000 CYCLES
8. MECHANICAL LIFE 500,000 CYCLES
9. OPERATING TEMP. -40°C TO 85°C
10. ▲ DENOTES CRITICAL PARAMETER
11. CONTACTS: BRASS, GOLD PLATED
TERMINALS: BRASS, GOLD FLASH PLATED

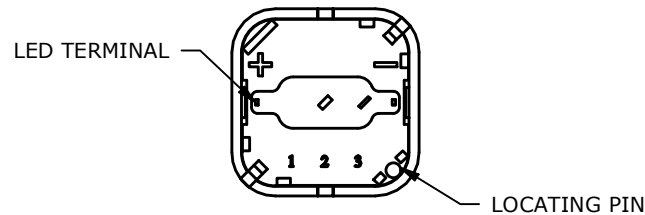
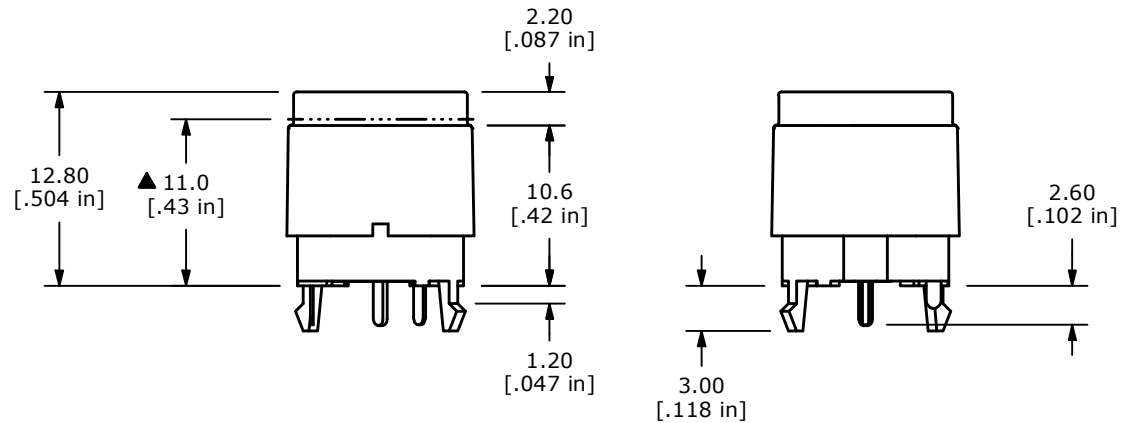
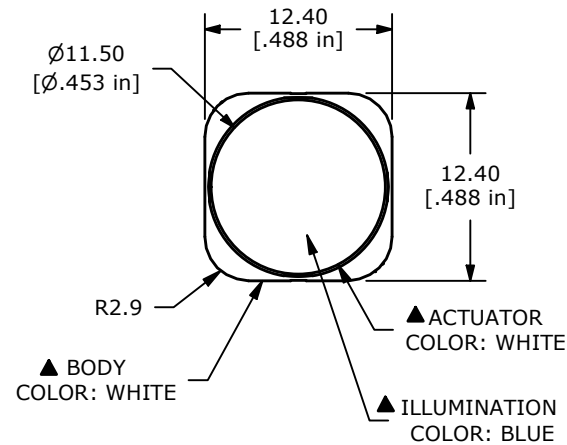

REV	ECO NO	DESCRIPTION	DATE	BY	E-SWITCH®				OBJECT ID
B	ECO-102679	11.0 WAS 11.8 AND 430 WAS 490	05/03/24	JS					100126313
A	ECO-102373	RELEASE	12/18/23	JS	TITLE PB350STRB				
THE INFORMATION CONTAINED IN THIS DOCUMENT IS PROPRIETARY TO E-SWITCH AND IS NOT TO BE COPIED OR TRANSFERRED					SCALE 2:1	DATE 12/6/2023	DR JS	DWG T003500	REV B