

NOTES:

1. ALL DIMENSIONS IN MM [INCH]
2. GENERAL TOLERANCE: X.X = ± 0.4
X.XX = ± 0.25
3. TERMINAL NUMBERS FOR REF. ONLY
- ▲ 4. RATING: 30mA @ 28VDC
5. TRAVEL: ELECTRICAL MAKE: 11.0 \pm 0.2mm
FULL TRAVEL: 2.0 \pm 0.30mm
6. OPERATING FORCE: 430 \pm 102gf
7. ELECTRICAL LIFE: 20,000 CYCLES
8. MECHANICAL LIFE 500,000 CYCLES
9. OPERATING TEMP. -40°C TO 85°C
10. ▲ DENOTES CRITICAL PARAMETER
11. CONTACTS: BRASS, GOLD PLATED
TERMINALS: BRASS, GOLD FLASH PLATED

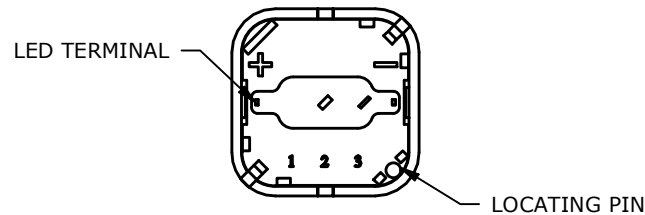
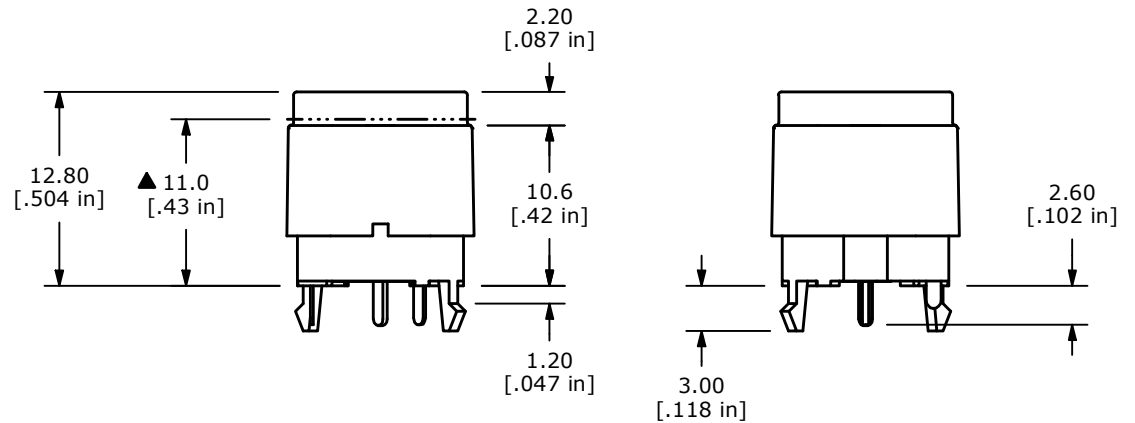
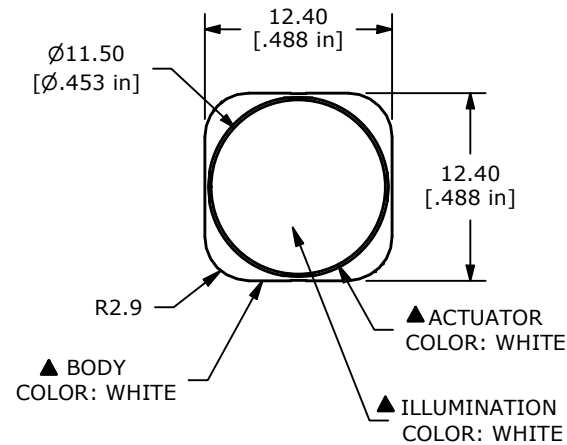

REV	ECO NO	DESCRIPTION	DATE	BY	E-SWITCH®				OBJECT ID
B	ECO-102679	11.0 WAS 11.8 AND 430 WAS 490	05/03/24	JS	TITLE PB350STRW				100126352
A	ECO-102373	RELEASE	12/18/23	JS					
THE INFORMATION CONTAINED IN THIS DOCUMENT IS PROPRIETARY TO E-SWITCH AND IS NOT TO BE COPIED OR TRANSFERRED					SCALE	DATE	DR	DWG	REV
					2:1	12/12/2023	JS	T003502	B