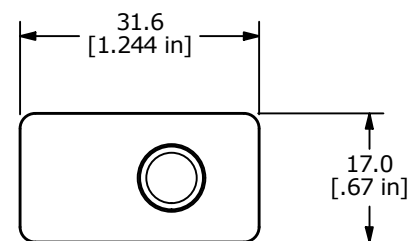
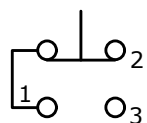
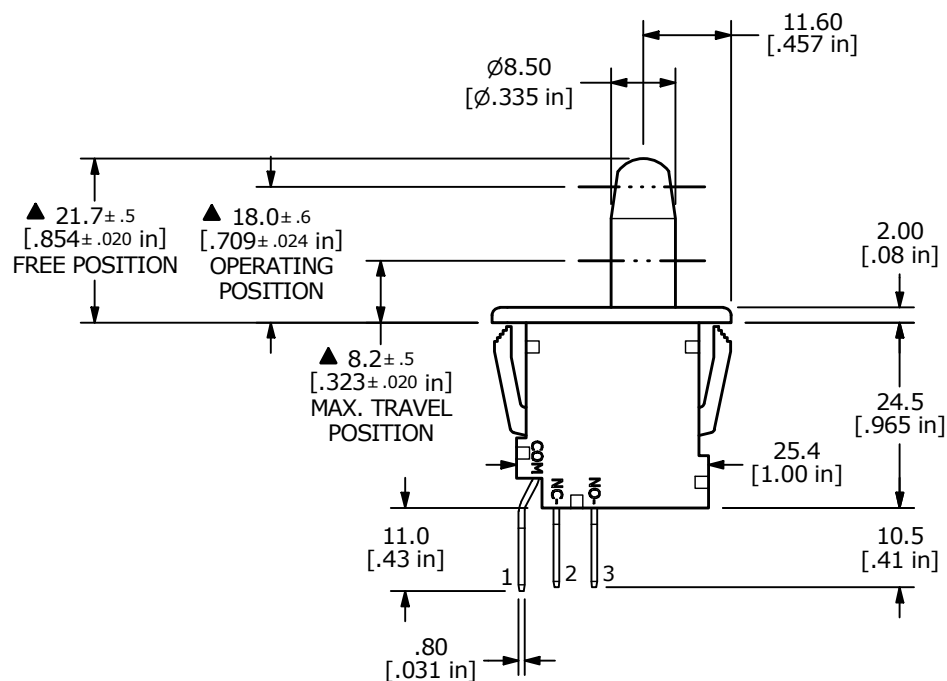
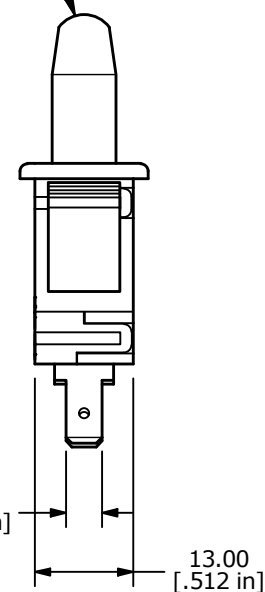
**PANEL CUTOUT**

PANEL THICKNESS 1mm to 2.5mm

▲ HOUSING
COLOR: BLACK

▲ SPDT
CONTACT CONFIGURATION
FUNCTION: ON-(ON)
(ON) = MOMENTARY

▲ ACTUATOR
COLOR: BLACK**NOTES:**

- ALL DIMENSIONS IN MM
- GENERAL TOLERANCE: X.X = ± 0.4
X.XX = ± 0.25
- TERM. NOS. FOR REFERENCE ONLY
- ELECTRICAL LIFE: 6,000 CYCLES
- OPERATING TEMP: 0°C to 85°C
- CONTACT RESISTANCE: 30mΩ MAX. INITIAL
- ▲ DENOTES CRITICAL PARAMETER
- CONTACT RATING: UL 16A 125VAC, 12A 250VAC, 1HP/250VAC

REV	ECO NO	DESCRIPTION	DATE	BY	E-SWITCH®				OBJECT ID
B	ECO-101214	print update	10/26/22	MW	TITLE PP1-1B7-1A1				000000995
					SCALE	DATE	DR	DWG	REV
					1:1	1/29/2015	rc	34-PP11B71A1	B

THE INFORMATION CONTAINED IN THIS DOCUMENT IS PROPRIETARY TO
E-SWITCH AND IS NOT TO BE COPIED OR TRANSFERRED