

SWITCH	WIRE	LENGTH
SW1-1	WIRE, 22 AWG AWM UL1007, WHITE	300.0 [11.8 in]
SW1-2	WIRE, 22 AWG AWM UL1007, YELLOW	300.0 [11.8 in]
SW1 RED (+)	WIRE, 22 AWG AWM UL1007, RED	300.0 [11.8 in]
SW1 BLUE (+)	WIRE, 22AWG AWM UL1007, BLUE	300.0 [11.8in]
SW1 GREEN (+)	WIRE, 22AWG AWM UL1007, GREEN	300.0 [11.8in]
SW C-(-)	WIRE, 22 AWG AWM UL1007, BLACK	300.0 [11.8 in]

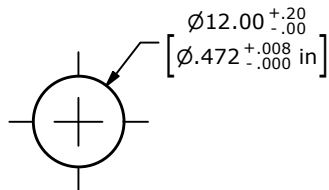

RECOMMENDED PANEL CUTOUT
MAX. PANEL THICKNESS 6.0 [.24 in]

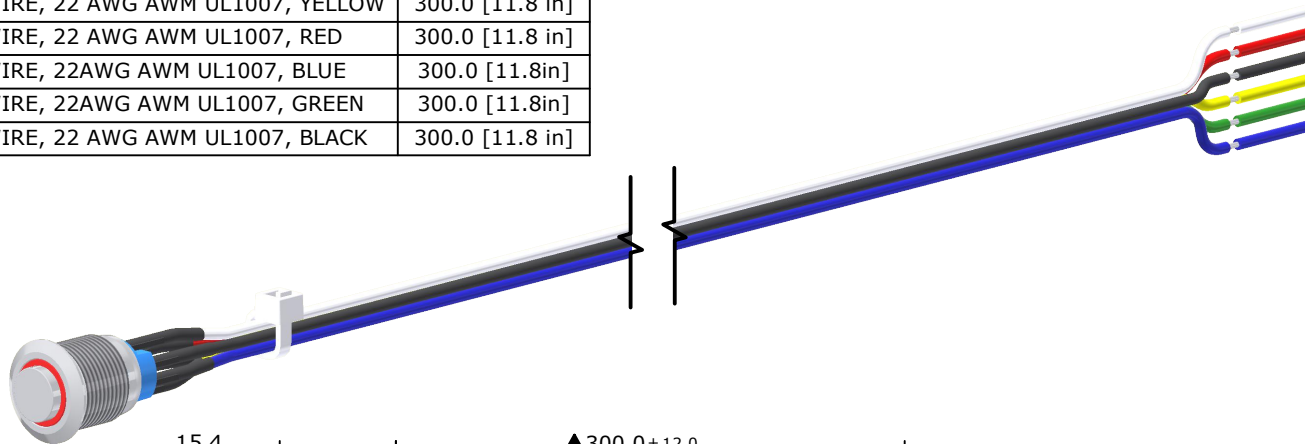
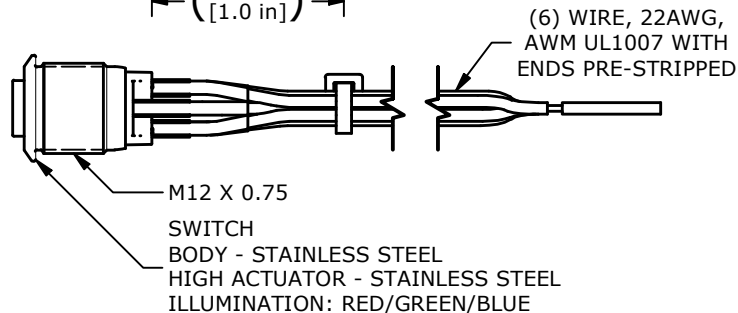
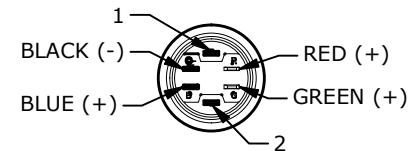
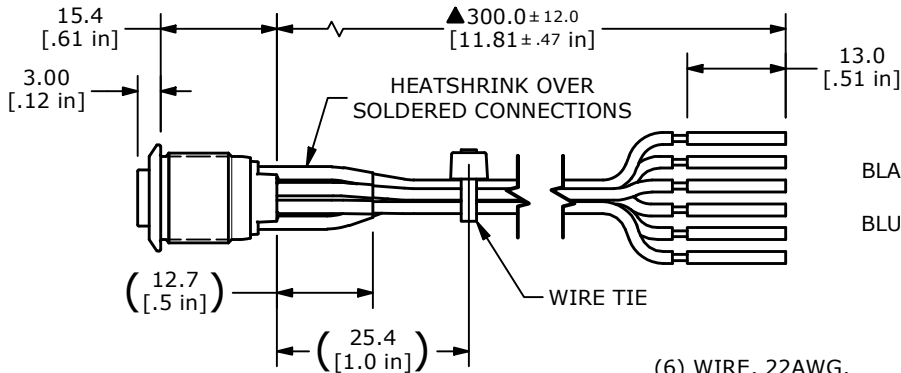
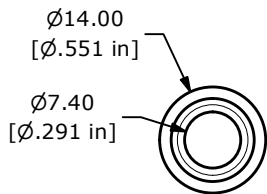

- NOTE:
- ALL DIMENSIONS IN MM [INCH]
 - GENERAL TOLERANCE: X.X = ± 0.4
X.XX = ± 0.25
 - TERMINAL NUMBERS FOR REF. ONLY
 - RATING: 2A @ 36VDC
 - CONTACT RESISTANCE: 50mΩ MAX. @ 1A 12VDC
 - INSULATION RESISTANCE: 100MΩ @ 500VDC
 - DIELECTRIC STRENGTH: 1,500V, RMS 50Hz, 1min
 - ELECTRICAL LIFE: 200,000 CYCLES
 - CONTACT MATERIAL: SILVER
 - OPERATING TEMPERATURE: -40°C to 85°C
 - INGRESS PROTECTION: IP65
 - CONTACT MATERIAL: SILVER
 - OPERATING TEMPERATURE: -40°C to 85°C
 - INGRESS PROTECTION: IP65
 - LED VOLTAGE: BASE VOLTAGE: RED 1.8V
GREEN 2.8V
BLUE 2.8V
 - ▲ DENOTES CRITICAL PARAMETER.
 - SUPPLIED HARDWARE: O-RING AND HEXNUT
 - USE P/N's DESIGNATED OR ENGINEERING APPROVED EQUIVALENTS

REV	ECO NO	DESCRIPTION	DATE	BY
A	ECO-103502	RELEASE	07/07/25	JS



OBJECT ID
100130523

TITLE PV0HW40SS-3R1				
SCALE 1:1	DATE 7/1/2025	DR JS	DWG 52-PV0HW40SS3R1	REV A