

PANEL MOUNTING
MAX. PANEL THICKNESS 6.0mm

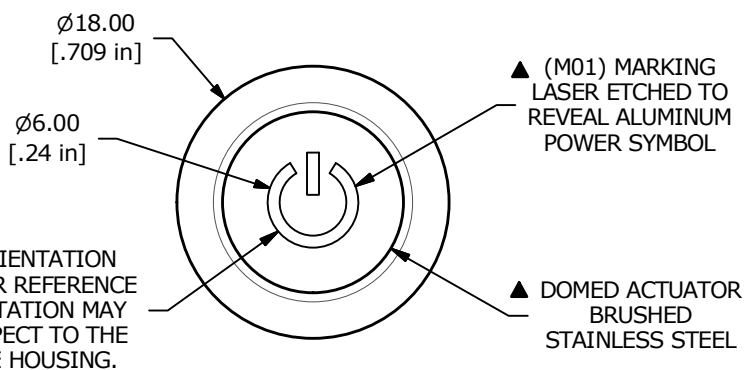

GRAPHIC ORIENTATION SHOWN IS FOR REFERENCE ONLY. ORIENTATION MAY VARY IN RESPECT TO THE FLAT ON THE HOUSING.

▲ (M01) MARKING LASER ETCHED TO REVEAL ALUMINUM POWER SYMBOL

▲ DOMED ACTUATOR BRUSHED STAINLESS STEEL



▲ SWITCH FUNCTION

POS. 1	POS. 2
OFF	(ON)
OPEN	1-2

(ON) = MOMENTARY

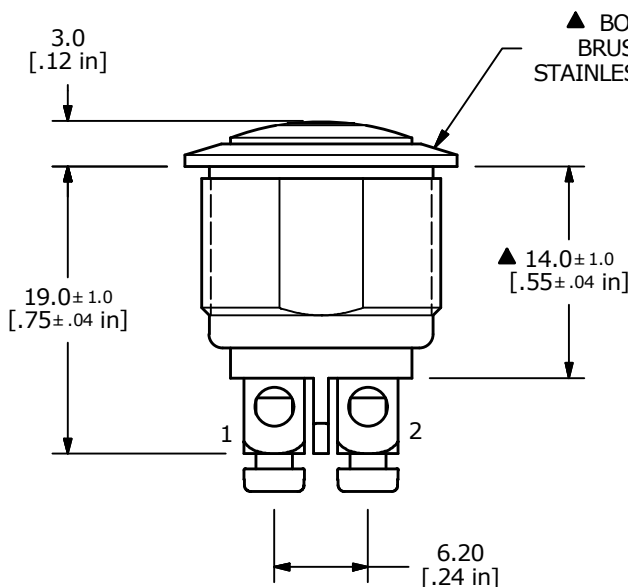
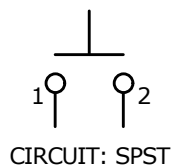

▲ BODY BRUSHED STAINLESS STEEL

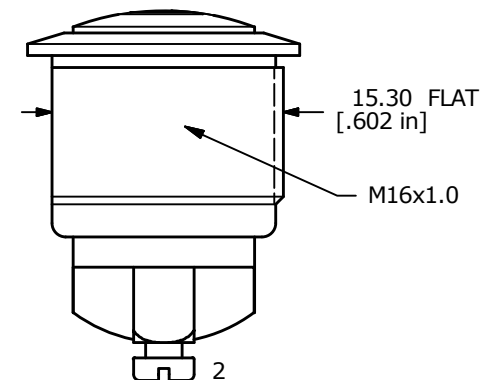

- NOTE:
- ALL DIMENSIONS IN MM [INCH]
 - GENERAL TOLERANCE: X.X = ±0.4
X.XX = ±0.25
 - TERMINAL NUMBERS FOR REF ONLY
 - CONTACT MATERIAL: GOLD
 - RATING: 2A @ 48VDC
 - TRAVEL: 1.5 ± 0.2mm
 - ELECTRIC LIFE: 200,000 MAKE-AND-BREAK CYCLES
 - INSULATION RESISTANCE: 1,000 MΩ MIN.
 - DIELECTRIC STRENGTH: 2,000 VAC MIN. FOR 1 MINUTE
 - CONTACT RESISTANCE: 50mΩ MAX. @ 1A 12VDC
 - OPERATING TEMP.: -20°C to 55°C
 - ▲ DENOTES CRITICAL PARAMETER.
 - INGRESS PROTECTION: IP65
 - ▲ 14. HARDWARE SUPPLIED: O-RING AND HEXNUT



A	23692	RELEASE	12/6/18	MW
REV	PCR NO	DESCRIPTION	DATE	BY

TITLE PV2S640BBG-M01				
SCALE 2:1	DATE 12/6/2018	DR MW	DWG 52-PV2S640BBGM01	REV A

THE INFORMATION CONTAINED IN THIS DOCUMENT IS PROPRIETARY TO E-SWITCH AND IS NOT TO BE COPIED OR TRANSFERRED