

SWITCH	WIRE	LENGTH
SW1-1	WIRE, 24AWG AWM UL1015, BLUE	300.0 [11.8 in]
SW1-2	WIRE, 24AWG AWM UL1015, WHITE	300.0 [11.8 in]
SW1-3	WIRE, 24AWG AWM UL1015, YELLOW	300.0 [11.8 in]

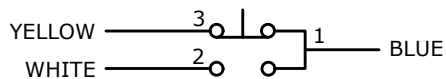

SCHEMATIC  
ON - (ON)

( ) = MOMENTARY FUNCTION

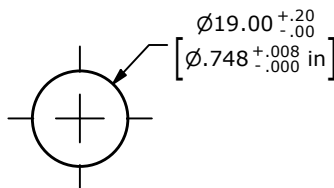
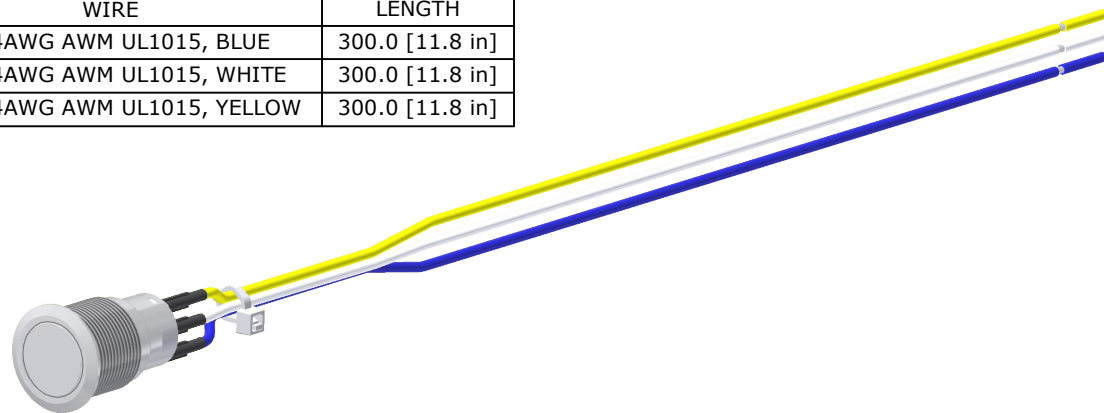

RECOMMENDED PANEL CUTOUT  
MAX. PANEL THICKNESS 11mm

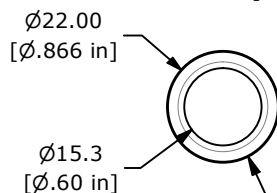
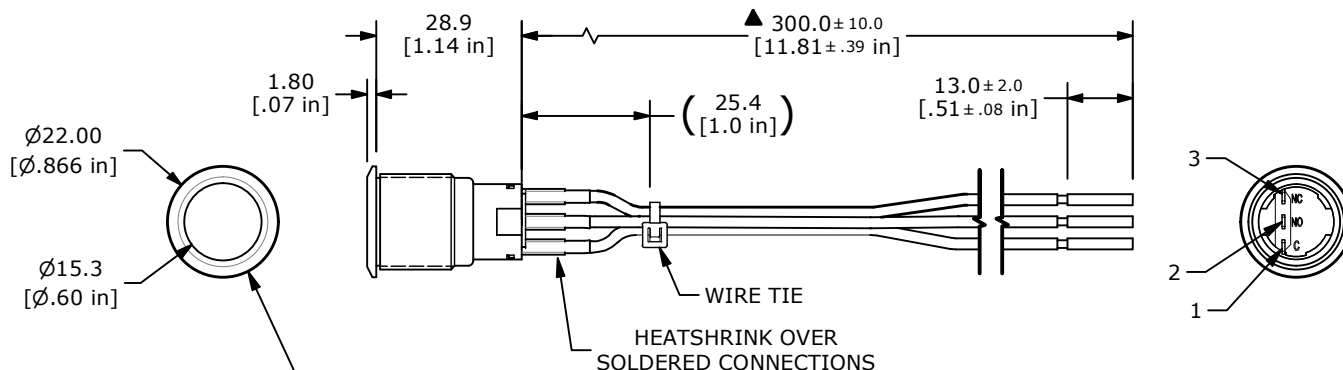

- NOTES:
- DIMENSIONS IN MM [INCH]
  - TERMINAL NUMBERS FOR REF. ONLY
  - CONTACT MATERIAL: SILVER
  - RATING: 2A 24VDC
  - LAMP VOLTAGE: NON-ILLUMINATED
  - INGRESS PROTECTION: IP65
  - TRAVEL: 2.8mm
  - OPERATING TEMP.: -20°C to 55°C
  - INSULATION RESISTANCE: 1,000 MΩ MIN.
  - CONTACT RESISTANCE: 50mΩ MAX. @ 1A 12VDC
  - DIELECTRIC STRENGTH: 2,000 VAC MIN. FOR 1 MINUTE
  - ELECTRICAL LIFE: 50,000 MAKE-AND-BREAK CYCLES AT FULL LOAD
  - ▲ DENOTES CRITICAL PARAMETER.
  - ALL MATERIAL SHALL BE ROHS COMPLIANT
  - ▲ SUPPLIED HARDWARE: O-RING AND HEXNUT
  - USE P/N'S DESIGNATED OR ENGINEERING APPROVED EQUIVALENTS

SWITCH (PV4F2B0SS)  
BODY - STAINLESS STEEL  
ACTUATOR - STAINLESS STEEL  
NON-ILLUMINATED

(3) WIRE, 24 AWG,  
AWM UL1015 WITH  
ENDS PRE-STRIPPED

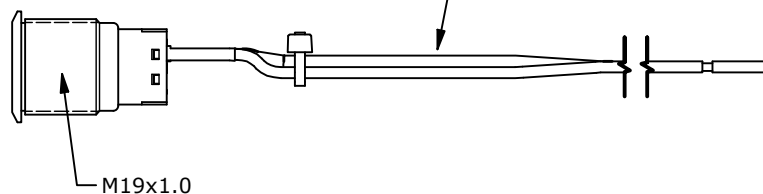

REV	ECO NO	DESCRIPTION	DATE	BY
A	ECO-103055	Release	11/08/24	MW



OBJECT ID  
100128687

TITLE PV4FWB0SS

SCALE	DATE	DR	DWG	REV
2:3	10/30/2024	MW	52-PV4FWB0SS	A

THE INFORMATION CONTAINED IN THIS DOCUMENT IS PROPRIETARY TO E-SWITCH AND IS NOT TO BE COPIED OR TRANSFERRED