

RECOMMENDED PANEL CUTOUT
MAX. PANEL THICKNESS 4mm

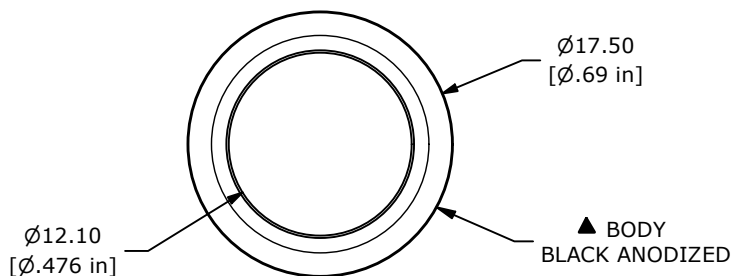

SWITCH FUNCTION	
POS. 1	POS. 2
OFF	(ON)
OPEN	1-2

(ON) = MOMENTARY

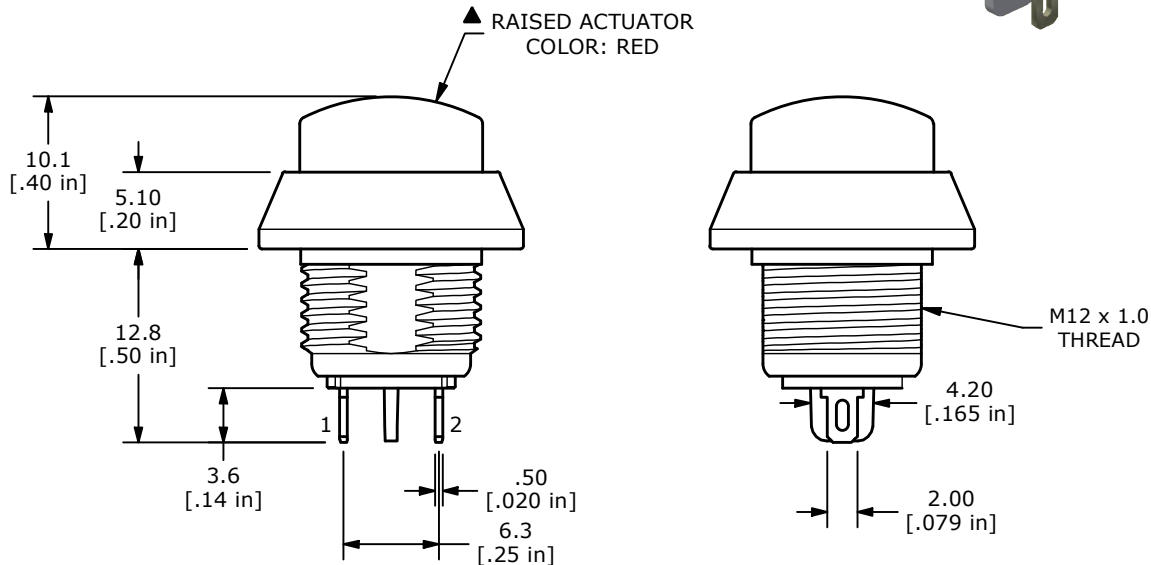
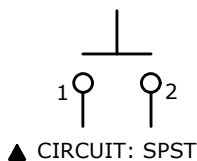

- NOTE:
1. ALL DIMENSIONS IN MM [INCH]
 2. GENERAL TOLERANCE: X.X = ±0.4
X.XX = ±0.25
 3. TERMINAL NUMBERS FOR REF ONLY
 - ▲ 4. CONTACT MATERIAL: SILVER PLATED
 5. RATING: 2A @ 36VDC
 6. ELECTRICAL LIFE: 200,000 CYCLES
 7. CONTACT RESISTANCE: 50 mΩ MAX. @ 1A 12VDC (INITIAL)
 8. INSULATION RESISTANCE: 1,000 MΩ MIN. @ 500VDC
 9. DIELECTRIC STRENGTH: 2,000 VAC rms.
 10. OPERATING TEMPERATURE: -40°C to +85°C
 11. PANEL THICKNESS MAX: 4.0mm
 12. INGRESS PROTECTION: IP65
 13. ▲ DENOTES CRITICAL PARAMETER.
 - ▲ 14. HARDWARE INCLUDED: O-RING and HEXNUT (NOT SHOWN)

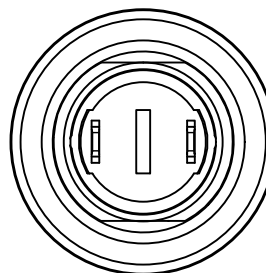

REV	ECO NO	DESCRIPTION	DATE	BY
C	ECO-103091	Print update	11/15/24	MW



OBJECT ID
000002785

TITLE PV5H24019				
SCALE 2:1	DATE 9/19/2011	DR CAB	DWG 52-PV5H24019	REV C