

RECOMMENDED PANEL CUTOUT  
MAX. PANEL THICKNESS 4mm

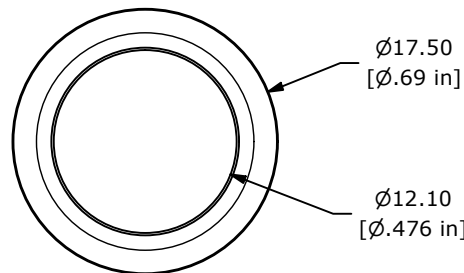

SWITCH FUNCTION	
POS. 1	POS. 2
OFF	(ON)
OPEN	1-2

(ON) = MOMENTARY

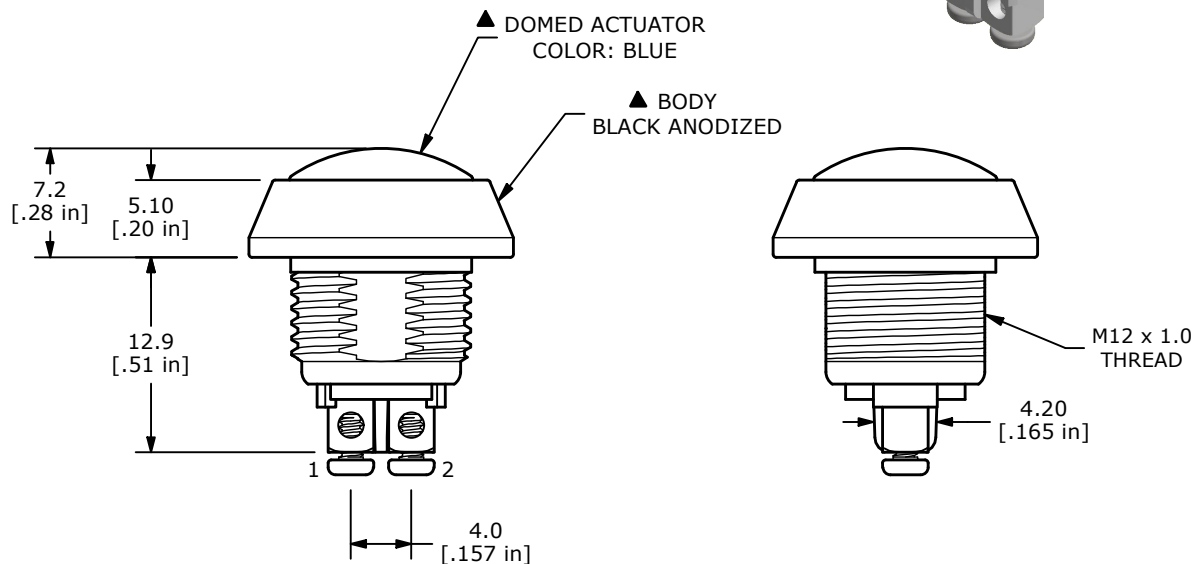
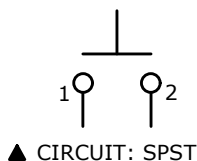

- NOTE:
- ALL DIMENSIONS IN MM [INCH]
  - GENERAL TOLERANCE: X.X = ±0.4  
X.XX = ±0.25
  - TERMINAL NUMBERS FOR REF ONLY
  - ▲ 4. CONTACT MATERIAL: SILVER PLATED
  5. RATING: 2A @ 36VDC
  6. ELECTRICAL LIFE: 200,000 CYCLES
  7. CONTACT RESISTANCE: 50 mΩ MAX. @ 1A 12VDC (INITIAL)
  8. INSULATION RESISTANCE: 1,000 MΩ MIN. @ 500VDC
  9. DIELECTRIC STRENGTH: 2,000 VAC rms.
  10. OPERATING TEMPERATURE: -40°C to +85°C
  11. PANEL THICKNESS MAX: 4.0mm
  12. INGRESS PROTECTION: IP65
  13. ▲ DENOTES CRITICAL PARAMETER.
  - ▲ 14. HARDWARE INCLUDED: O-RING and HEXNUT (NOT SHOWN)

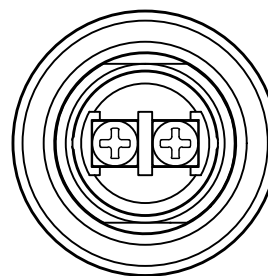

REV	ECO NO	DESCRIPTION	DATE	BY
C	ECO-103080	print update	11/12/24	MW



OBJECT ID  
000002811

TITLE PV5S64017				
SCALE 2:1	DATE 8/5/2009	DR CAB	DWG 52-PV5S64017	REV C