

▲ SCHEMATIC
OFF-ON / ON-OFF
SPDT ILLUMINATED

SWITCH	WIRE	LENGTH
SW1-1	WIRE, 24AWG AWM UL1015, WHITE	300.0 [11.8 in]
SW1-2	WIRE, 24AWG AWM UL1015, WHITE	300.0 [11.8 in]
SW1-3	WIRE, 24AWG AWM UL1015, BLUE	300.0 [11.8 in]
SW1-4	WIRE, 24AWG AWM UL1015, BLUE	300.0 [11.8 in]
SW1- (+)	WIRE, 24AWG AWM UL1015, RED	300.0 [11.8 in]
SW1- (-)	WIRE, 24AWG AWM UL1015, BLACK	300.0 [11.8 in]

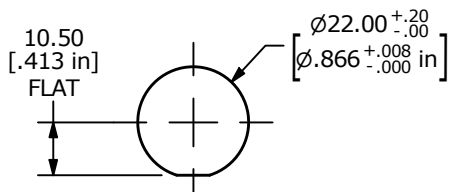

RECOMMENDED PANEL CUTOUT
MAX. PANEL THICKNESS 12.0 [.47 in]

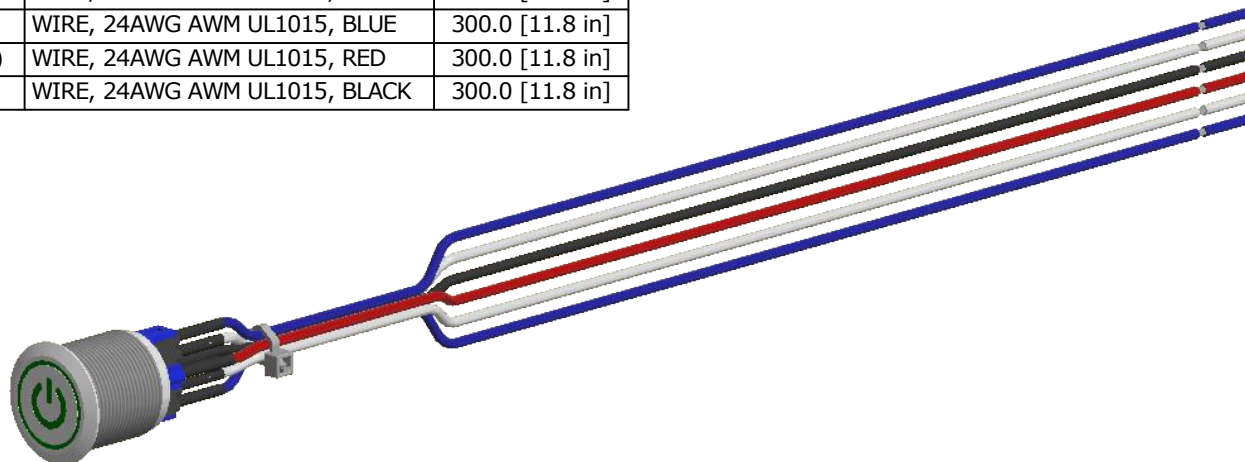
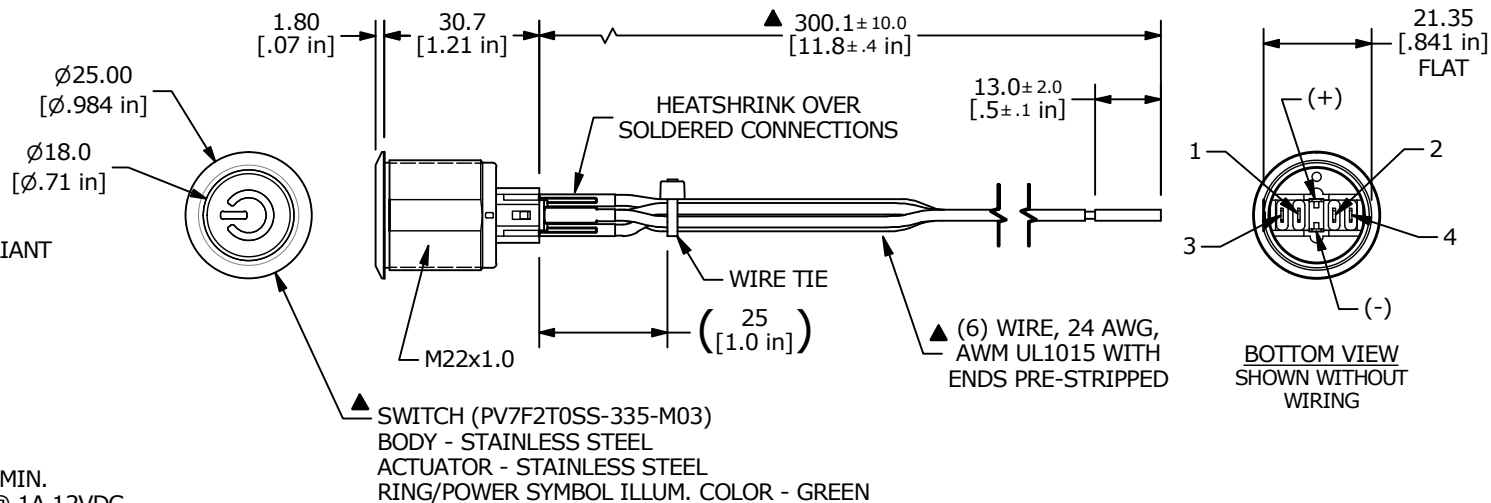

NOTES:

1. DIMENSIONS IN MM [INCH]
2. ALL MATERIAL SHALL BE ROHS COMPLIANT
3. TERMINAL NUMBERS FOR REF. ONLY
4. CONTACT MATERIAL: SILVER
5. RATING: 2A 48VDC
- ▲ 6. LAMP VOLTAGE: 24V
7. INGRESS PROTECTION: IP65
8. TRAVEL: 2.2mm
9. ACTUATION FORCE: 4N
10. OPERATING TEMP.: -20°C to 55°C
11. INSULATION RESISTANCE: 1,000 MΩ MIN.
12. CONTACT RESISTANCE: 50mΩ MAX. @ 1A 12VDC
13. DIELECTRIC STRENGTH: 2,000 VAC MIN. FOR 1 MINUTE
14. ELECTRIC LIFE: 50,000 CYCLES.
15. ▲ DENOTES CRITICAL PARAMETER.
- ▲ 16. SUPPLIED HARDWARE: O-RING and HEXNUT
17. USE P/N's DESIGNATED OR ENGINEERING APPROVED EQUIVALENTS

▲ SWITCH (PV7F2T0SS-335-M03)
BODY - STAINLESS STEEL
ACTUATOR - STAINLESS STEEL
RING/POWER SYMBOL ILLUM. COLOR - GREEN



A	24662	RELEASE	12/28/20	MW
REV	PCR NO	DESCRIPTION	DATE	BY

TITLE PV7FWT0SS-335-M03				
SCALE	DATE	DR	DWG	REV
2:3	12/28/2020	MW	52-PV7FWT0SS335M03	A