

SCHEMATIC
 ON-(ON) - SPDT ILLUMINATED
 () DENOTES MOMENTARY FUNCTION

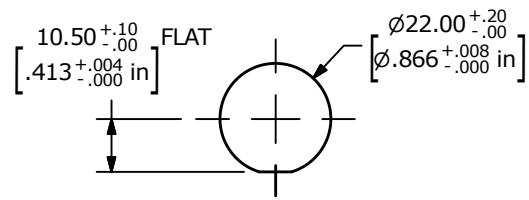

RECOMMENDED PANEL CUTOUT
 MAX. PANEL THICKNESS 10.0 [.39 in]

- NOTES:**
1. DIMENSIONS IN MM [INCH]
 2. ALL MATERIAL SHALL BE ROHS COMPLIANT
 3. TERMINAL NUMBERS FOR REF. ONLY
 4. CONTACT MATERIAL: SILVER
 5. RATING: 2A 24VDC
 6. INGRESS PROTECTION: IP65
 7. TRAVEL: 2.8mm
 8. OPERATING TEMP.: -25°C to 55°C
 9. INSULATION RESISTANCE: 1,000 MΩ MIN.
 10. CONTACT RESISTANCE: 50mΩ MAX. @ 1A 12VDC
 11. DIELECTRIC STRENGTH: 2,000 VAC MIN. FOR 1 MINUTE
 12. ELECTRIC LIFE: 50,000 MAKE-AND-BREAK CYCLES AT FULL LOAD.
 13. ▲ DENOTES CRITICAL PARAMETER.
 - ▲ 14. HARDWARE: O-RING AND HEXNUT SUPPLIED IN BULK IN A PLASTIC BAG.
 - ▲ 15. USE PART NUMBERS DESIGNATED OR ENGINEERING APPROVED EQUIVALENTS
 - ▲ 16. ILLUMINATION COLOR: RGB (RED / GREEN / BLUE)
 - ▲ 17. ILLUMINATION VOLTAGE: RED-1.8V, GREEN-2.8V, BLUE-2.8V

SWITCH	WIRE	LENGTH
SW1-1 (C)	WIRE, 24AWG AWM UL1015, ORANGE	300.0 [11.8 in]
SW1-2 (NO)	WIRE, 24AWG AWM UL1015, WHITE	300.0 [11.8 in]
SW1-3 (NC)	WIRE, 24AWG AWM UL1015, YELLOW	300.0 [11.8 in]
SW1-RED (+)	WIRE, 24AWG AWM UL1015, RED	300.0 [11.8 in]
SW1-GREEN (+)	WIRE, 24AWG AWM UL1015, GREEN	300.0 [11.8 in]
SW1-BLUE (+)	WIRE, 24AWG AWM UL1015, BLUE	300.0 [11.8 in]
SW1-(-)	WIRE, 24AWG AWM UL1015, BLACK	300.0 [11.8 in]

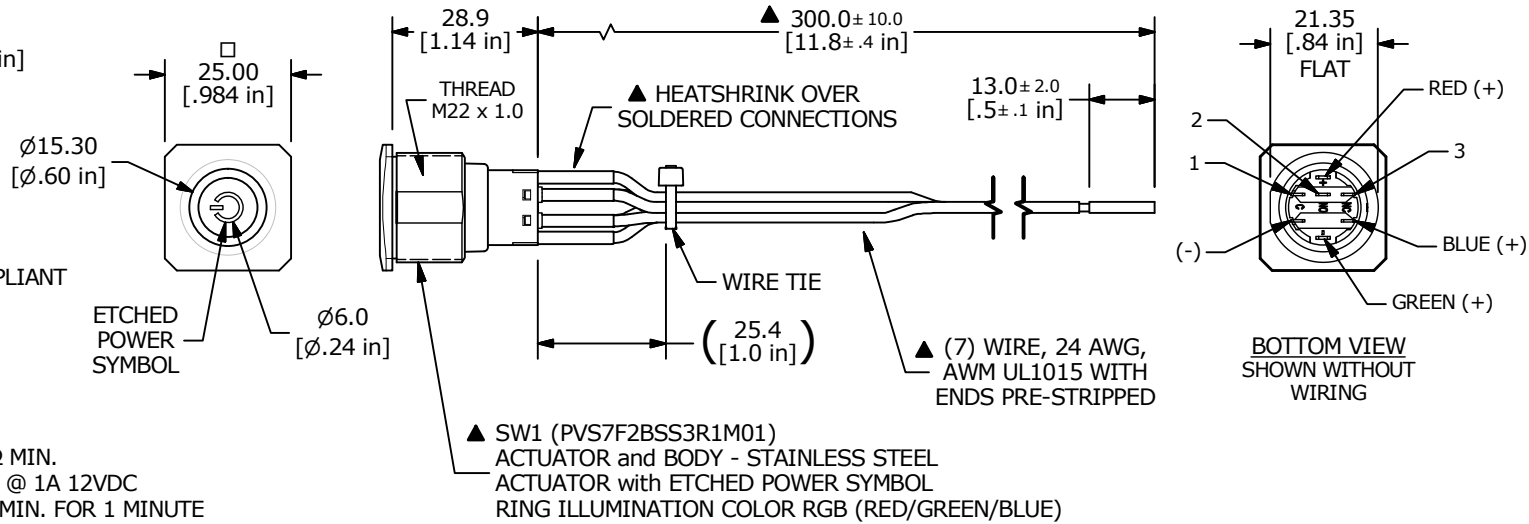
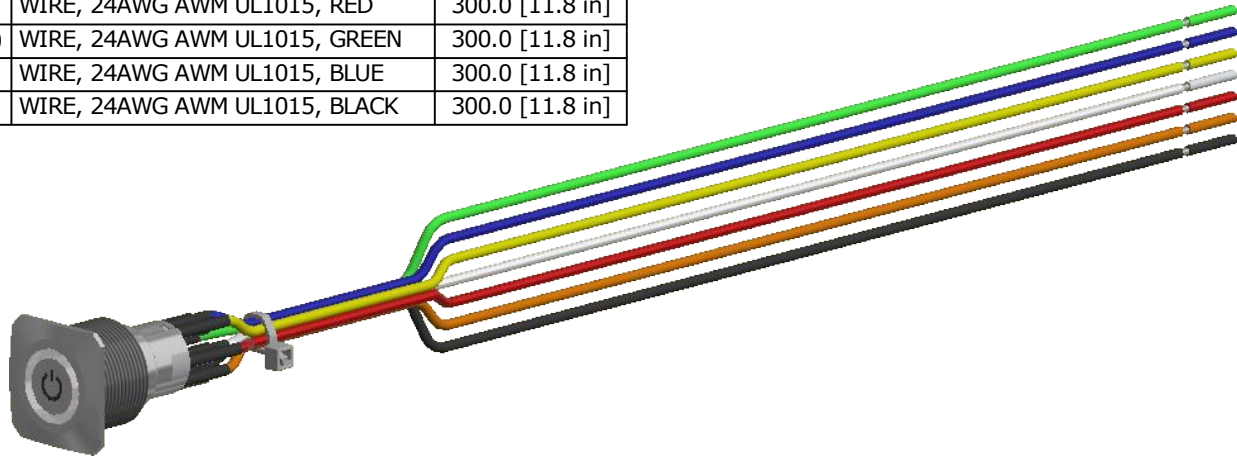

A	24079	NEW RELEASE	10/25/19	MW
REV	PCR NO	DESCRIPTION	DATE	BY

TITLE PVS7FWBSS-3R1-M01				
SCALE	DATE	DR	DWG	REV
2:3	10/25/2019	MW	52-PVS7FWBSS3R1M01	A

THE INFORMATION CONTAINED IN THIS DOCUMENT IS PROPRIETARY TO E-SWITCH AND IS NOT TO BE COPIED OR TRANSFERRED