

SWITCH FUNCTION	
POS. 1	POS. 2
OFF	(ON)
None	1-2

( ) = MOMENTARY

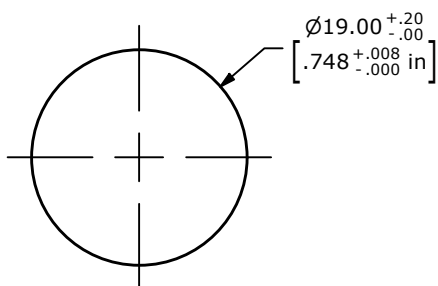

RECOMMENDED PANEL CUTOUT  
 PANEL THICKNESS 1 - 5mm

NOTE:

1. ALL DIMENSIONS IN MM [INCH]
2. GENERAL TOLERANCE: X.X =  $\pm 0.4$   
 X.XX =  $\pm 0.25$
3. TERMINAL NUMBERS FOR REF ONLY
4. CONTACT MATERIAL: Silver
5. RATING: 50mA 24VDC
6. ELECTRIC LIFE: 500,000 MAKE-AND-BREAK CYCLES AT FULL LOAD.
7. INSULATION RESISTANCE: 1000 M $\Omega$  MIN.
8. DIELECTRIC STRENGTH: 250 VAC MIN. FOR 1 MINUTE
9. CONTACT RESISTANCE: 100m $\Omega$  MAX.
10. OPERATING TEMP.: -40°C to +85°C
11. TRAVEL: 0.5mm
12. ▲ DENOTES CRITICAL PARAMETER.
13. INGRESS PROTECTION: IP65
- ▲ 14. LED VOLTAGE: 2.8V
15. HARDWARE SUPPLIED: O-RING AND HEXNUT

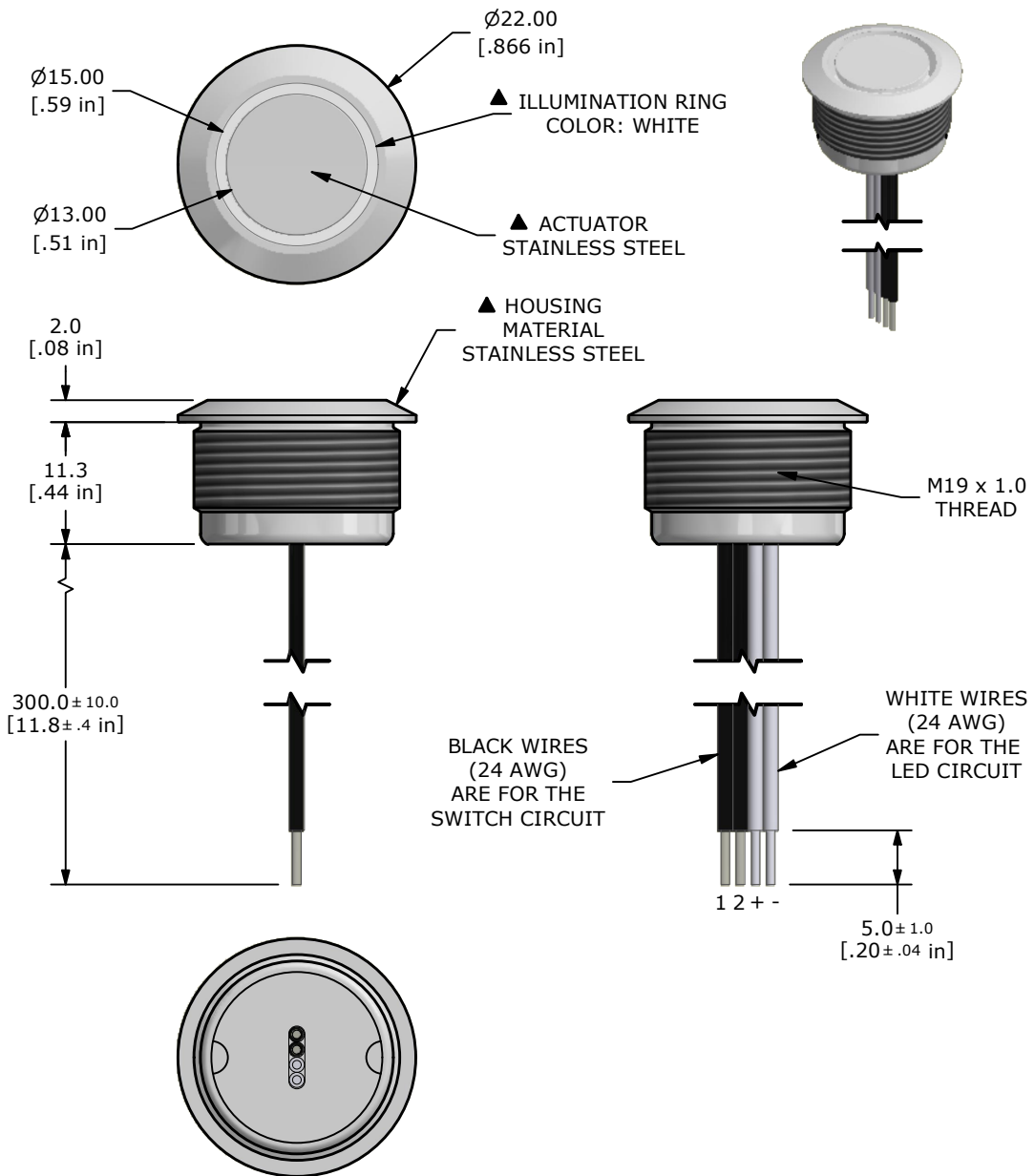

REV	ECO NO	DESCRIPTION	DATE	BY
B	ECO-103995	TEMP TO -40 - 85C	03/12/26	JS



OBJECT ID  
 100117433

TITLE PVT4FW4SS301				
SCALE 3:2	DATE 7/22/2021	DR JM	DWG 52-PVT4FW4SS301	REV B