

REAL CODE

	C	1	2	4	8	
0	●					0
1	●	●				1
2	●		●			2
3	●		●			3
4	●			●		4
5	●	●		●		5
6	●		●	●		6
7	●	●	●	●		7
8	●				●	8
9	●	●			●	9
10			●		●	A
11	●	●			●	B
12			●	●		C
13	●		●	●		D
14		●	●	●		E
15	●	●	●	●		F

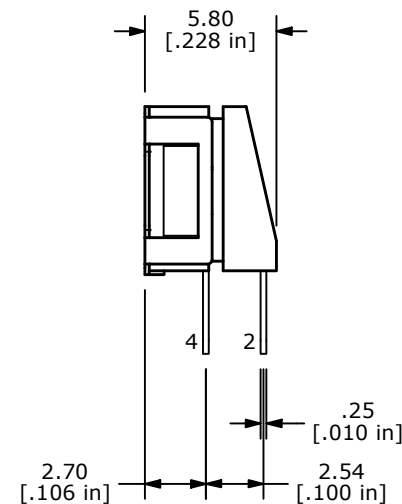
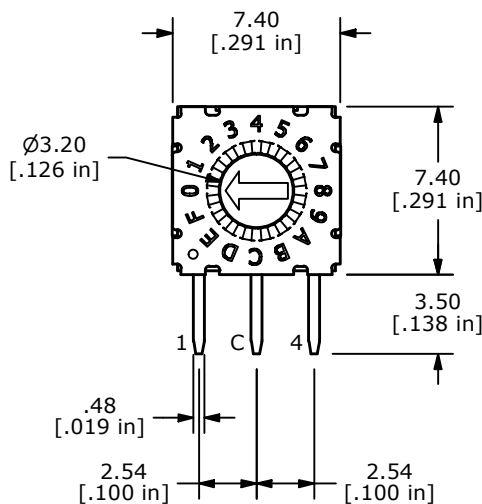

NOTES:

1. ALL DIMENSIONS IN MM [INCH]
2. GENERAL TOLERANCE: X.X = ±0.4
X.XX = ±0.30
3. TERMINAL NUMBERS FOR REFERENCE ONLY
4. OPERATING FORCE: 250gf.cm Max.
5. CONTACT RATING: 100mA 42V DC (SWITCHING)
400mA 42V DC (NON-SWITCHING)
6. CONTACT RESISTANCE: 80mΩ MAX.
7. INSULATION RESISTANCE: 100MΩ MIN @ 250VDC
8. DIELECTRIC STRENGTH: 250VAC 1 MIN.
9. LIFE: 25,000 STEPS
10. OPERATING TEMPERATURE: -60°C to 125°C
- ▲ 11. PACKAGING: 65 PCS TUBE
12. IP RATING: IP67
13. ▲ DENOTES CRITICAL PARAMETER

REV	ECO NO	DESCRIPTION	DATE	BY
B	ECO-102774	print update	06/06/24	MW



OBJECT ID
000026624

TITLE RDMAR16R2T				
SCALE	DATE	DR	DWG	REV
3:1	1/31/2014	EBP	U100015	B