

PCB LAYOUT

COMPLEMENT CODE

	C	I	Z	4	8	
0	●	●	●	●	●	0
1	●		●	●	●	1
2	●	●		●	●	2
3	●			●	●	3
4	●	●	●		●	4
5	●		●		●	5
6	●	●			●	6
7	●				●	7
8	●	●	●	●		8
9	●		●	●		9
10	●	●		●		A
11	●			●		B
12	●		●			C
13	●					D
14	●	●				E
15	●					F

16 POSITIONS

NOTES:

- ALL DIMENSIONS IN MM [INCH]
- GENERAL TOLERANCE: X.X = ± 0.4
X.XX = ± 0.25
- TERMINAL NUMBERS FOR REFERENCE ONLY
- OPERATING FORCE: 700gf/cm MAX.
- CONTACT RATING: 150mA, 42V DC (SWITCHING)
200mA 42V DC (NON-SWITCHING)
- CONTACT RESISTANCE: 80mΩ MAX.
- INSULATION RESISTANCE: 100MΩ MIN @ 250VDC
- DIELECTRIC STRENGTH: 250VAC 1 MIN.
- LIFE: 10,000 STEPS
- OPERATING TEMPERATURE: -40°C to 85°C
- ▲ 11. PACKAGING: 50 PCS PER TUBE
(Segment Wheel is to ship separate from the Switch)
- ▲ DENOTES CRITICAL PARAMETER

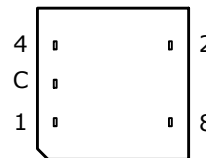
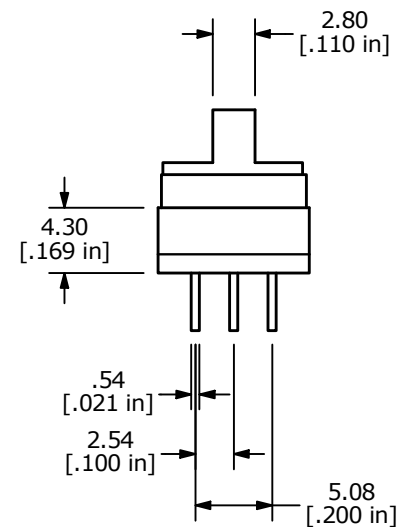
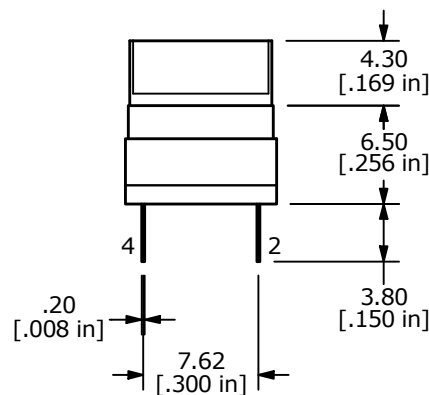
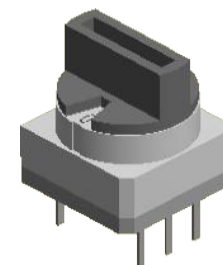
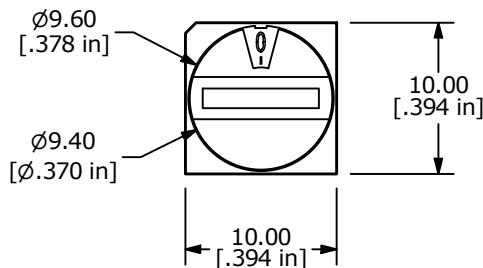

IMPORTANT ASSEMBLY NOTE:

THE SEGMENT WHEEL ACTUATOR IS SHIPPED SEPARATELY FROM THE SWITCH AND MUST BE ASSEMBLED AFTER SOLDERING.
THE SEGMENT WHEEL ACTUATOR CANNOT WITHSTAND THE HIGH TEMPERATURES OF AUTOMATED SOLDERING.

REV	ECO NO	DESCRIPTION	DATE	BY
A	ECO-101532	RELEASE	12/29/22	JS



OBJECT ID
100123352

TITLE RDTKC16P2T				
SCALE	DATE	DR	DWG	REV
2:1	12/22/2022	JS	U200058	A