

PCB LAYOUT

REAL CODE

	C	1	2	4	8	
0	●					0
1	●	●				1
2	●		●			2
3	●	●	●			3
4	●			●		4
5	●	●		●		5
6	●		●	●		6
7	●	●	●	●		7
8	●				●	8
9	●	●			●	9
10	●		●		●	A
11	●	●			●	B
12	●		●		●	C
13	●	●			●	D
14	●		●		●	E
15	●	●	●	●	●	F

16 POSITIONS

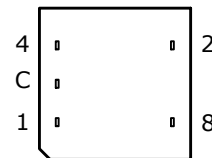
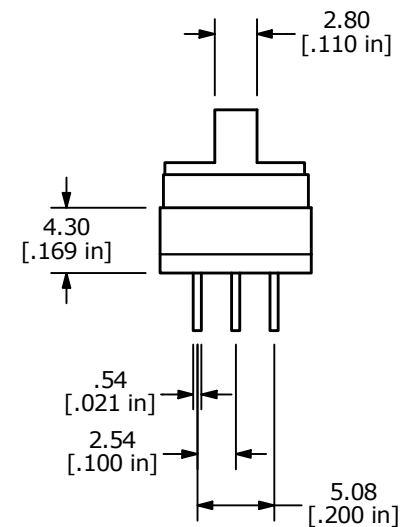
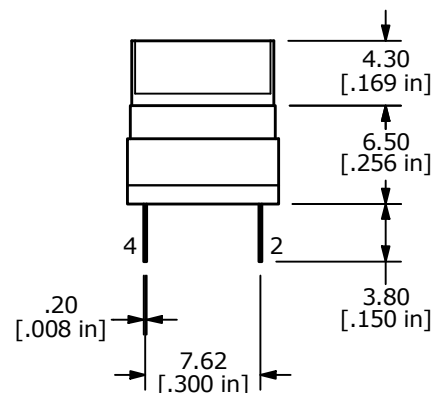
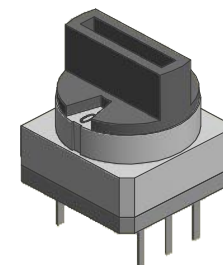
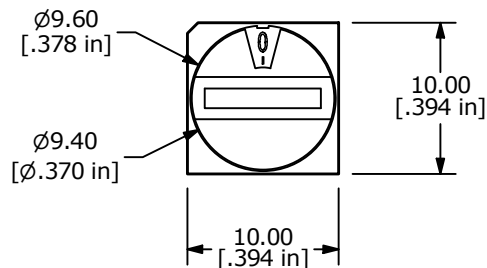

NOTES:

- ALL DIMENSIONS IN MM [INCH]
- GENERAL TOLERANCE: X.X = ± 0.4
X.XX = ± 0.25
- TERMINAL NUMBERS FOR REFERENCE ONLY
- OPERATING FORCE: 700gf/cm MAX.
- CONTACT RATING: 150mA, 42V DC (SWITCHING)
200mA 42V DC (NON-SWITCHING)
- CONTACT RESISTANCE: 80mΩ MAX.
- INSULATION RESISTANCE: 100MΩ MIN @ 250VDC
- DIELECTRIC STRENGTH: 250VAC 1 MIN.
- LIFE: 10,000 STEPS
- OPERATING TEMPERATURE: -40°C to 85°C
- ▲ 11. PACKAGING: 50 PCS PER TUBE
(Segment Wheel is to ship separate from the Switch)
- ▲ DENOTES CRITICAL PARAMETER

IMPORTANT ASSEMBLY NOTE:
THE SEGMENT WHEEL ACTUATOR IS SHIPPED SEPARATELY FROM THE SWITCH AND MUST BE ASSEMBLED AFTER SOLDERING.
THE SEGMENT WHEEL ACTUATOR CANNOT WITHSTAND THE HIGH TEMPERATURES OF AUTOMATED SOLDERING.

REV	ECO NO	DESCRIPTION	DATE	BY		OBJECT ID
A	ECO-101294	Release	10/14/22	MW		100122794
					TITLE	RDTKR16P2T
THE INFORMATION CONTAINED IN THIS DOCUMENT IS PROPRIETARY TO E-SWITCH AND IS NOT TO BE COPIED OR TRANSFERRED			SCALE	DATE	DR	REV
			2:1	9/28/2022	MW	A
					DWG	
					U200057	