

| LED PARAMETER | FORWARD CURRENT | FORWARD VOLTAGE @ 20mA | LUMINOUS INTENSITY |
|---------------|-----------------|------------------------|--------------------|
| UNITS         | mA              | V                      | mcd                |
| RED           | 20              | 2.0 - 2.5              | 700                |

## NOTE:

1. ALL DIMENSIONS IN MM [INCH]
2. GENERAL TOLERANCE: X.X =  $\pm 0.4$   
X.XX =  $\pm 0.25$
3. TERMINAL NUMBERS FOR REF ONLY
- ▲ 4. CIRCUIT: SPST, OFF-ON, LATCHING
5. CONTACT MATERIAL: Gold over SILVER
6. RATING: 100mA @ 24 VDC
7. ELECTRIC LIFE: 200,000 CYCLES AT FULL LOAD
8. CONTACT RESISTANCE: 50 m $\Omega$  max. (INITIAL)
9. INSULATION RESISTANCE: 1,000 M $\Omega$  min. @ 500VDC
10. DIELECTRIC STRENGTH: 1,000 VAC rms.
11. OPERATING FORCE: 350gf  $\pm 150$ gf
12. OPERATING TEMPERATURE: -30°C to +85°C
13. CONTACT BOUNCE: 10ms MAX.
14. TRAVEL: 2.5mm  $\pm 0.25$ mm
15. PANEL THICKNESS RANGE: 1.5 - 4.0 mm.
16. ▲ DENOTES CRITICAL PARAMETER.
17. MAX MOUNTING TORQUE: 0.5 Nm APPLIED TO THE NUT
- ▲ 18. HARDWARE INCLUDED:
  1. T081101 LOCK WASHER (Qty 1)
  2. T081102 HEX NUT (Qty 1)
  3. T081103 O-RING (Qty 1)
19. SEAL RATING: IP67 AT THE FRONT PANEL

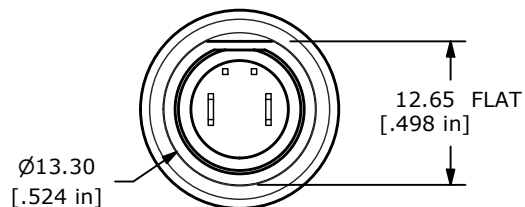
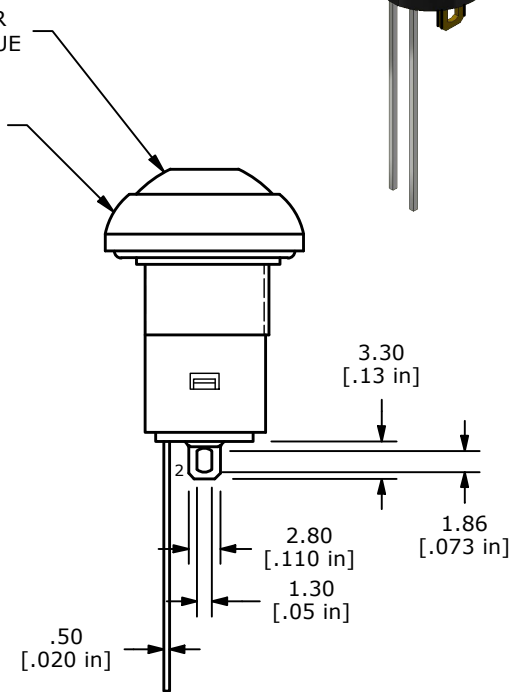
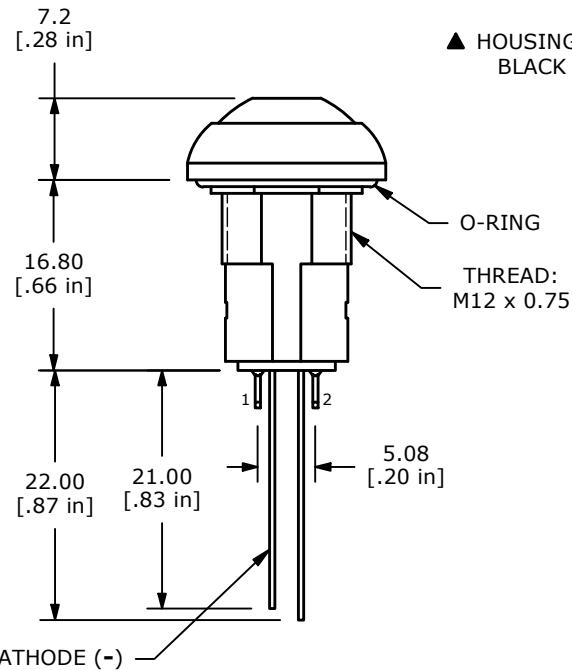

| REV | ECO NO     | DESCRIPTION            | DATE     | BY | E-SWITCH®                   |           |    |          | OBJECT ID |
|-----|------------|------------------------|----------|----|-----------------------------|-----------|----|----------|-----------|
| B   | ECO-102841 | NOTE 17 0.5 NM WAS 1.5 | 07/12/24 | JS | TITLE RP8200B2M1CEBLKBLURED |           |    |          | 000022800 |
|     |            |                        |          |    | SCALE                       | DATE      | DR | DWG      | REV       |
|     |            |                        |          |    | 3:2                         | 10/2/2017 | rc | ST082012 | B         |

THE INFORMATION CONTAINED IN THIS DOCUMENT IS PROPRIETARY TO E-SWITCH AND IS NOT TO BE COPIED OR TRANSFERRED