

▲ **CIRCUIT: SPST**
OFF - (ON)
(MOMENTARY)

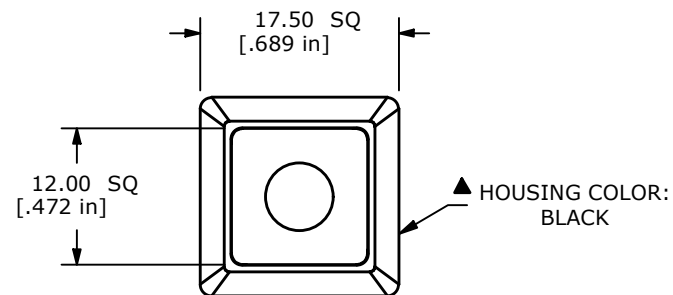

NOTE:

1. ALL DIMENSIONS IN MM [INCH]
2. GENERAL TOLERANCE: X.X = ±0.4
X.XX = ±0.25
3. TERMINAL NUMBERS FOR REF ONLY
4. CONTACT MATERIAL: GOLD OVER SILVER
5. RATING: 125mA @ 125 VAC
100mA @ 50 VDC
6. ELECTRIC LIFE: 500,000 CYCLES AT FULL LOAD
7. CONTACT RESISTANCE: 50 mΩ MAX. (INITIAL)
8. INSULATION RESISTANCE: 1,000 MΩ MIN. @ 500VDC.
9. DIELECTRIC STRENGTH: 1,000 VAC FOR 1 MINUTE.
10. OPERATING FORCE: 2N~5N
11. OPERATING TEMPERATURE: -30°C TO +85°C.
12. CONTACT BOUNCE: 10ms MAX.
13. TRAVEL: 1.5 ±0.25MM
14. PANEL THICKNESS RANGE: 1.5 - 4.0 mm.
15. ▲ DENOTES CRITICAL PARAMETER.
16. MAX TORQUE APPLIED TO MOUNTING NUT: 0.5Nm
- ▲ 17. HARDWARE INCLUDED: T081101 LOCK WASHER (QTY 1)
T081102 HEX NUT (QTY 1)
T081100 RUBBER SEAL (QTY 1)
18. SEAL RATING: IP67 AT THE FRONT PANEL

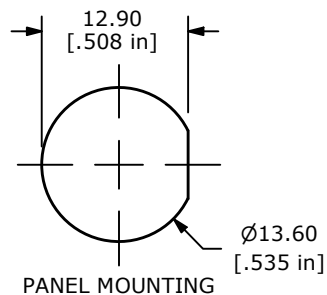
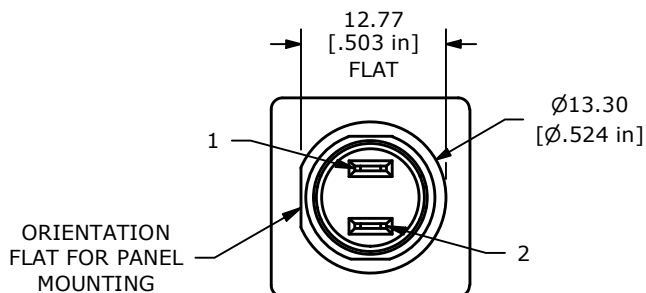
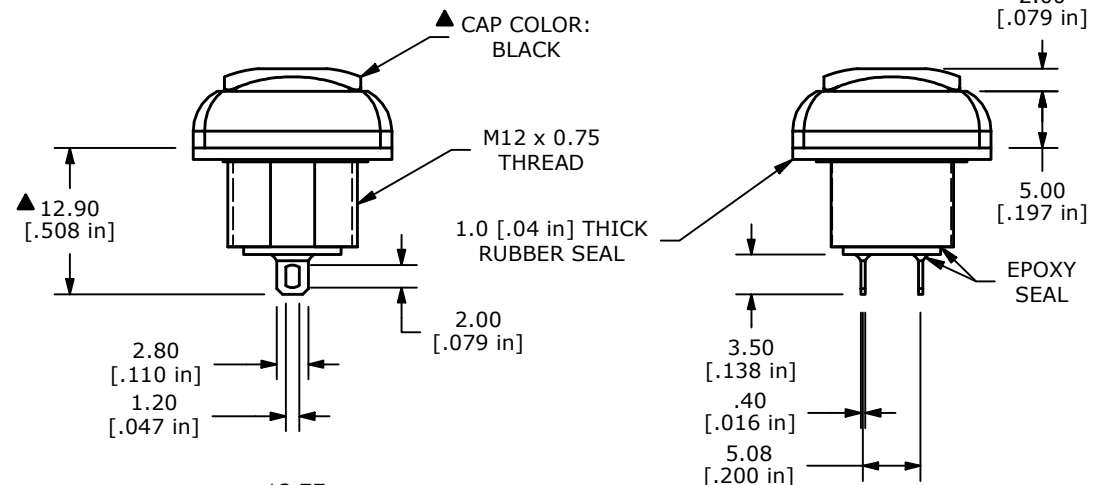

REV	ECO NO	DESCRIPTION	DATE	BY	E-SWITCH®				OBJECT ID
C	ECO-103497	REMOVED SIDE RETENTION SLOTS	07/14/25	MR	TITLE RP8500B2M1CEBLKBLKNIL				000022832
					SCALE	DATE	DR	DWG	REV
					3:2	3/22/2018	MJR	ST085003	C

THE INFORMATION CONTAINED IN THIS DOCUMENT IS PROPRIETARY TO
E-SWITCH AND IS NOT TO BE COPIED OR TRANSFERRED