

NOTE:

1. ALL DIMENSIONS IN MM [INCH]
2. GENERAL TOLERANCE: X.X = ±0.4
X.XX = ±0.25
3. TERMINAL NUMBERS FOR REF ONLY
4. CONTACT MATERIAL: SILVER
5. RATING: 2A 36 VDC
6. ELECTRIC LIFE: 200,000 CYCLES
7. DIELECTRIC STRENGTH: 2,000 VAC MIN. FOR 1 MINUTE
8. CONTACT RESISTANCE: 50mΩ MAX. @ 1A 12VDC
9. OPERATING TEMP.: -20°C to 70°C
11. ▲ DENOTES CRITICAL PARAMETER.
- ▲ 12. LAMP VOLTAGE: RED 20mA 2.0V TYP., GREEN 20mA 3.1V TYP.
13. TRAVEL: 1.80mm
14. ACTUATION FORCE: 4.5 ± 1.5 N
15. MOUNTING NUT TORQUE: 1-3 Nm
16. INGRESS PROTECTION: IP67, IK10
17. HARDWARE SUPPLIED: O-RING AND HEXNUT

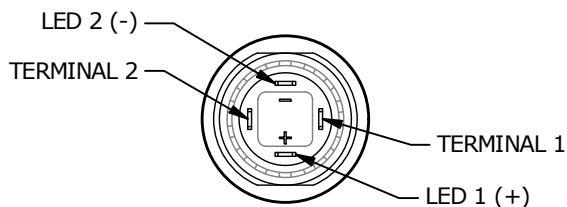

REV	ECO NO	DESCRIPTION	DATE	BY
D	ECO-101750	print update	03/20/23	MW

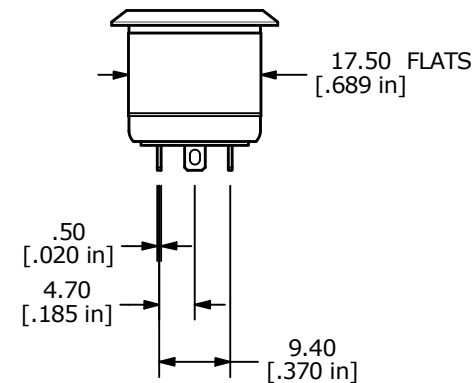
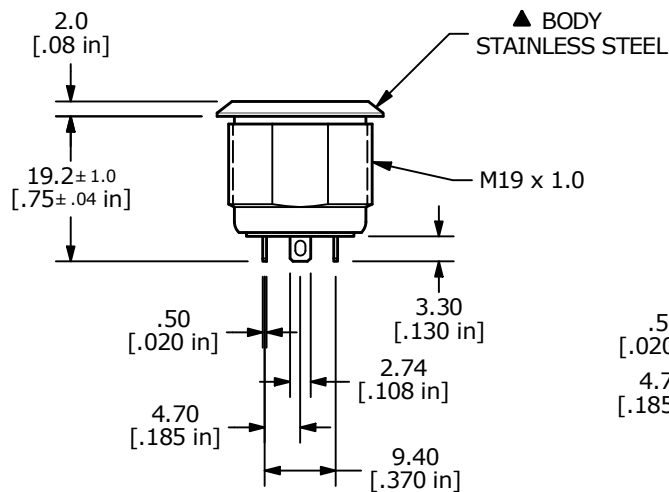
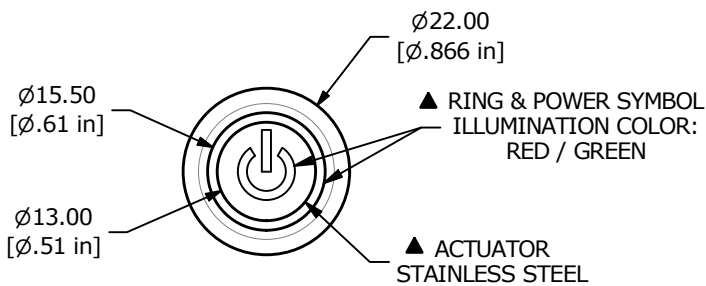

OBJECT ID
000025964

TITLE SV4F23SS-6G1				
SCALE	DATE	DR	DWG	REV
1:1	11/5/2019	MJR	T840001	D