

NOTES:

1. ALL DIMENSIONS IN MM [INCH]
2. GENERAL TOLERANCE: X.X=±0.4  
X.XX=±0.25
3. TERMINAL NUMBERS FOR REF. ONLY
4. CONTACT RATING: 0.1A @ 30VDC
- ▲ 5. TRAVEL: FULL = 2.5±0.3; LOCK = 1.5±0.3mm'S
6. OPERATING FORCE: 250±100gf
7. ELECTRICAL LIFE: 10,000 CYCLES
8. ▲ DENOTES CRITICAL PARAMETER
9. CONTACT MATERIAL: SILVER
10. CONTACT RESISTANCE: 50m OHM MAX.
11. OPERATING TEMPERATURE: -20c TO +70c
12. INSULATION RESISTANCE: 100M OHMS MIN.
- ▲ 13. LED COLOR: YELLOW
14. 2002/95/EC (RoHS) COMPLIANT AND HALOGEN FREE

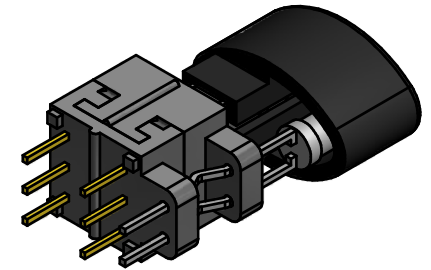

LED SPECS▲	UNITS	YELLOW
FORWARD CURRENT	mA	20
FORWARD VOLTAGE	V	2.0 TYP - 2.5 MAX
LUMINOUS INTENSITY	MCD	700 MIN - 1300 TYP

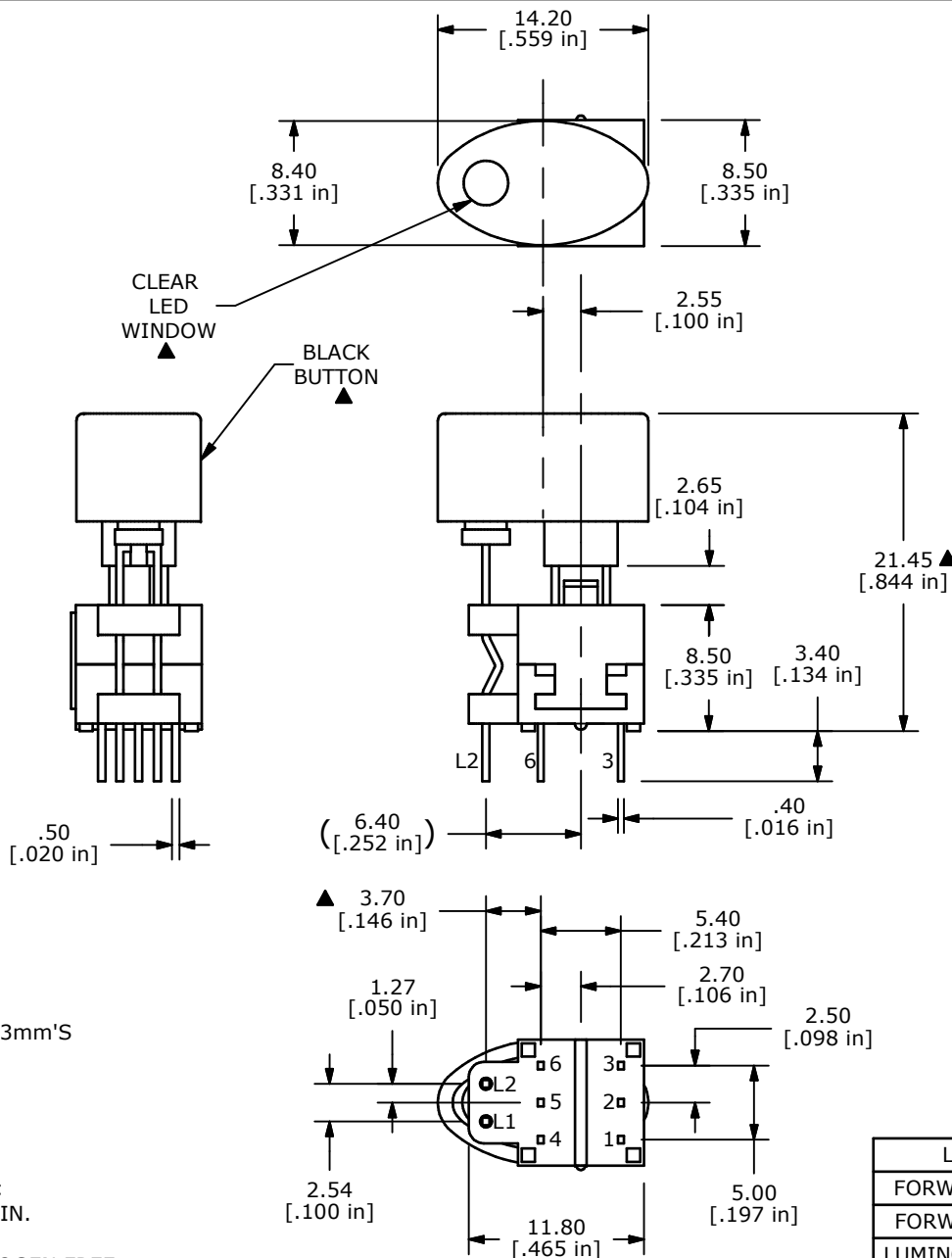

TITLE TL2205EEBPYB

A	21540	INITIAL RELEASE	8/6/14	EBP
REV	PCR NO	DESCRIPTION	DATE	BY

SCALE	DATE	DR	DWG	REV
	8/6/2014	EBP	B401017	A

THE INFORMATION CONTAINED IN THIS DOCUMENT IS PROPRIETARY TO E-SWITCH AND IS NOT TO BE COPIED OR TRANSFERRED