

LED SPECS	UNITS	RED	GREEN
FORWARD CURRENT	mA	20	20
FORWARD VOLTAGE	V	1.95 TYP - 2.5 MAX	2.1 TYP - 2.5 MAX
LUMINOUS INTENSITY	mcd	4000 TYP	300 TYP

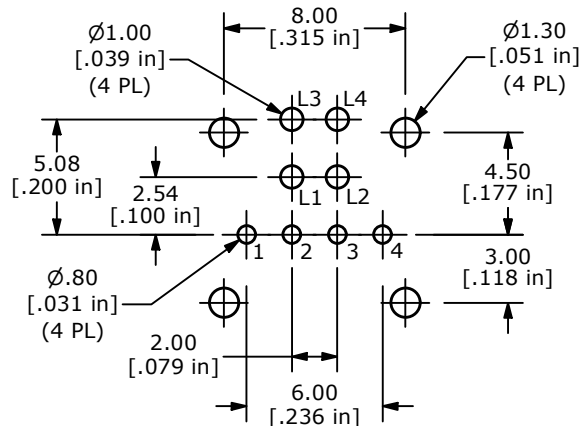

RECOMMENDED PCB LAYOUT

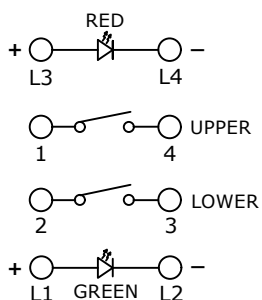

CIRCUIT DIAGRAM

NOTES:

1. ALL DIMENSIONS IN MM
2. GENERAL TOLERANCE: X.X = ±0.4
X.XX = ±0.25
3. TERM. NUMBERS FOR REFERENCE ONLY.
4. CONTACT RATING: 50mA @12VDC
5. TRAVEL: 0.25 ±0.1mm
6. CONTACT RESISTANCE: 100 Milli-Ohms Max.
7. OPERATING FORCE: 160 ±50gf
- ▲ 8. CONTACT MATERIAL: SILVER
9. MECHANICAL LIFE: 500,000 CYCLES
10. OPERATING TEMP: -40°C to 85°C
11. ▲ DENOTES CRITICAL PARAMETER.
- ▲ 12. PACKAGE: TRAY

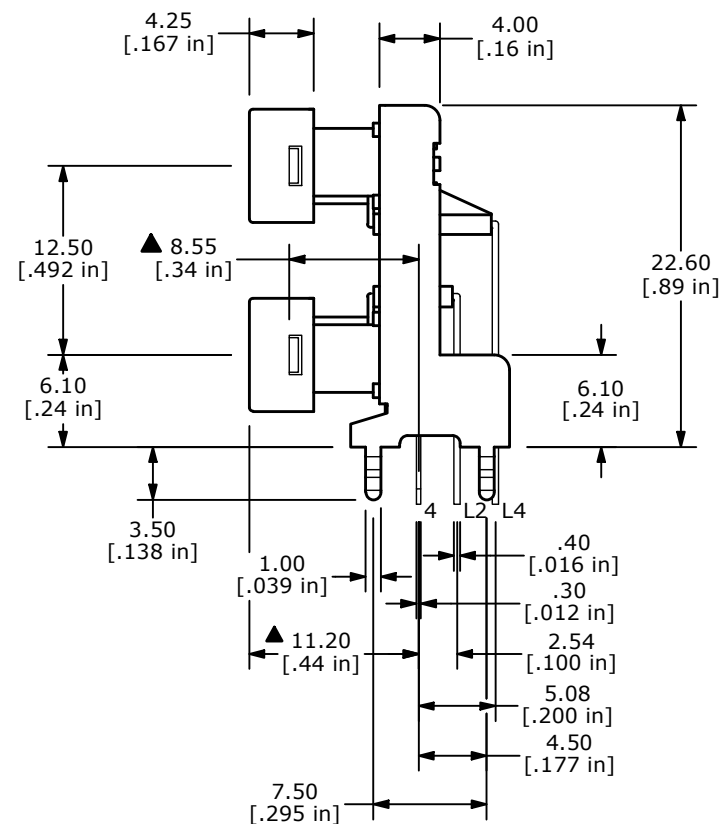
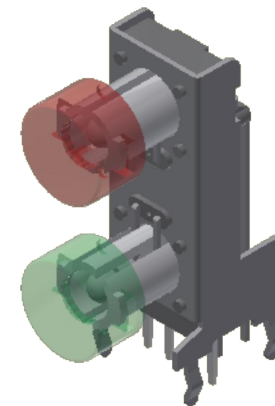
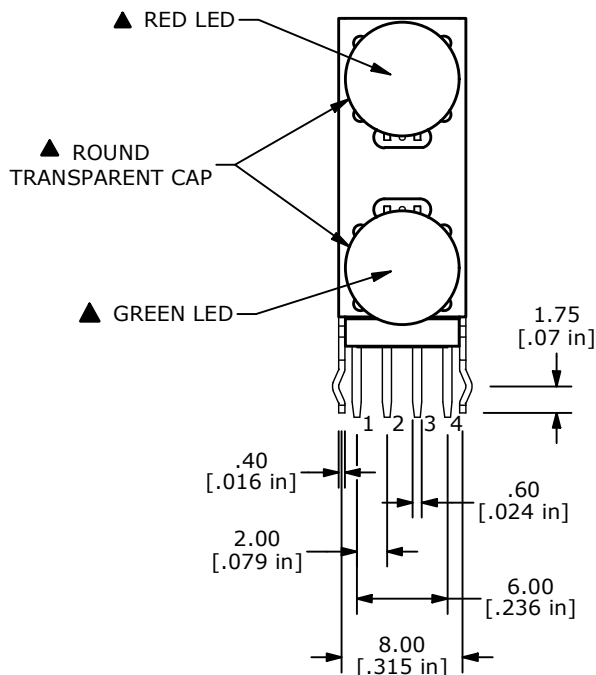
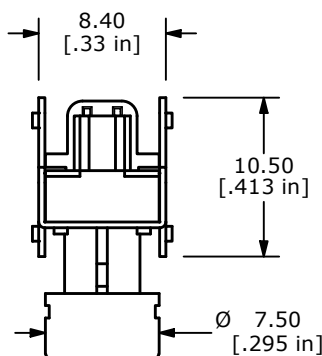

REV	ECO NO	DESCRIPTION	DATE	BY
B	ECO-102232	NOTE 12 REMOVE PACKAGE QUANTITY	09/13/23	JS



OBJECT ID
000006201

TITLE TL3253BRBBGBF160Q				
SCALE 2:1	DATE 7/1/2020	DR MW	DWG B060021	REV B