

CIRCUIT: SPST

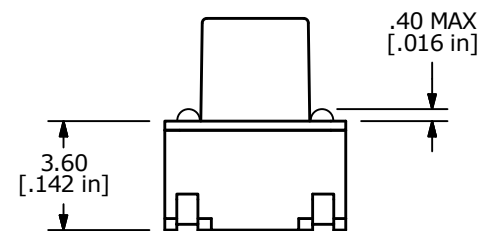

NOTES:

1. ALL DIMENSIONS IN MM
2. GENERAL TOLERANCE: X.X = ±0.4  
X.XX = ±0.25
3. TERM. NUMBERS FOR REFERENCE ONLY.
4. RATING: 50VDC, 50mA
- ▲ 5. OPERATING FORCE: 100 ± 50gf
6. TRAVEL: 0.25mm +0.2/-0.1mm
7. CONTACT RESISTANCE: 100 MILLI OHMS MAX. (INITIAL)
8. MECHANICAL/ELECTRICAL LIFE 100,000 CYCLES MIN.
- ▲ 9. SILVER CONTACTS
- ▲ 10. PACKAGE: 750 PCS PER TAPE AND REEL
11. ▲ DENOTES CRITICAL PARAMETER

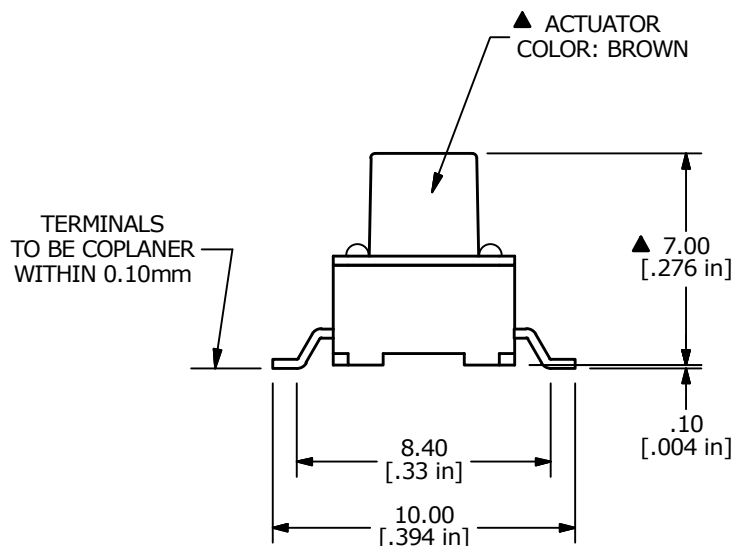

B	24001	correct note 10 to 750	8/14/19	MW
A	20785	NEW RELEASE	9/27/12	rc
REV	PCR NO	DESCRIPTION	DATE	BY

TITLE TL3301FF100QG				
SCALE	DATE	DR	DWG	REV
4:1	9/27/2012	rc	P010548	B

THE INFORMATION CONTAINED IN THIS DOCUMENT IS PROPRIETARY TO E-SWITCH AND IS NOT TO BE COPIED OR TRANSFERRED