

PCB LAYOUT

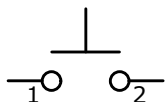

▲ CIRCUIT: SPST

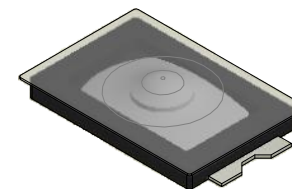
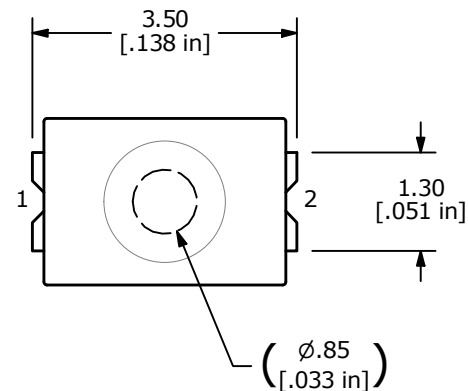

NOTES:

1. ALL DIMENSIONS IN MM [INCH]
2. GENERAL TOLERANCE: $x.x = \pm 0.4$
 $x.xx = \pm 0.25$
3. TERMINAL NUMBERS FOR REF. ONLY
4. CONTACT MATERIAL: SILVER
5. CONTACT RATING: 50mA; 12VDC
6. TRAVEL: 0.13 ± 0.05 mm
- ▲ 7. OPERATING FORCE: 100 ± 50 gf
8. ELECTRICAL LIFE: 300,000 CYCLES
9. CONTACT RESISTANCE: $500m\Omega$ MAX.
10. ▲ DENOTES CRITICAL PARAMETER
11. BOUNCE: 10m SECONDS MAX
12. INSULATION RESISTANCE: $50M\Omega$ MIN @ 100VDC.
13. DIELECTRIC STRENGTH: 250VAC FOR 1 MINUTE WITH NO BREAK DOWN
14. OPERATING TEMPERATURE: -40C to +85C

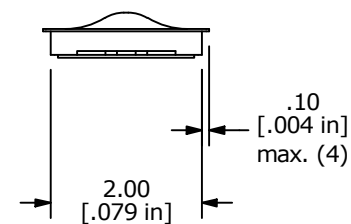
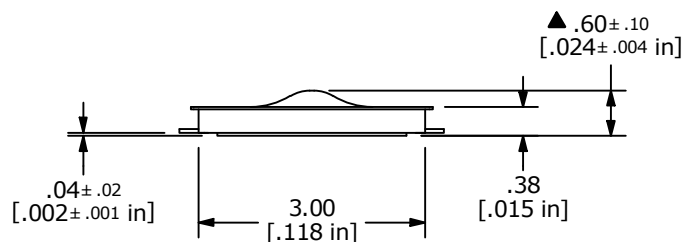

| | | | | |
|-----|--------|-------------------|--------|----|
| B | 24479 | Updated Terminals | 9/9/20 | MW |
| A | 22666 | New Release | 1/9/17 | rc |
| REV | PCR NO | DESCRIPTION | DATE | BY |

THE INFORMATION CONTAINED IN THIS DOCUMENT IS PROPRIETARY
TO E-SWITCH AND IS NOT TO BE COPIED OR TRANSFERRED

TITLE TL3780AF100QG

SCALE 10:1

DATE 1/9/2017

DR rc

DWG P003022

REV B