

CIRCUIT: SPST ▲

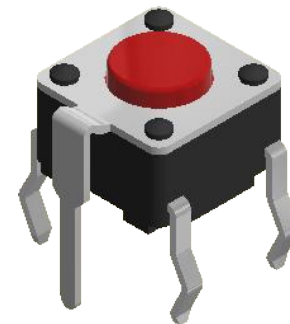

NOTES:

1. ALL DIMENSIONS IN MM [INCH]
2. GENERAL TOLERANCE: $X.X = \pm 0.4$
 $X.XX = \pm 0.25$
3. TERM. NUMBERS FOR REF. ONLY.
4. RATING: 50mA @ 12VDC
- ▲ 5. OPERATING FORCE: $250 \pm 50\text{gf}$
6. TRAVEL: $0.25 + 0.2/-0.1\text{mm}$
7. CONTACT RESISTANCE: $100\text{ m}\Omega$ MAX.
- ▲ 8. CONTACT MATERIAL: SILVER
9. DIELECTRIC STRENGTH: 250V RMS min.
10. INSULATION RESISTANCE: $100\text{ MEGA}\Omega$ min.
11. ELECTRICAL LIFE: 100,000 CYCLES
12. ▲ DENOTES CRITICAL PARAMETER.
13. OPERATING TEMP: -40°C to 85°C
14. PACKAGE: POLYBAG / 750 PIECES PER BAG

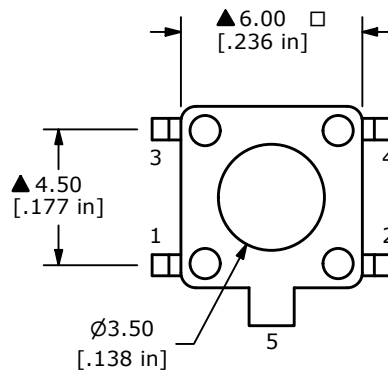
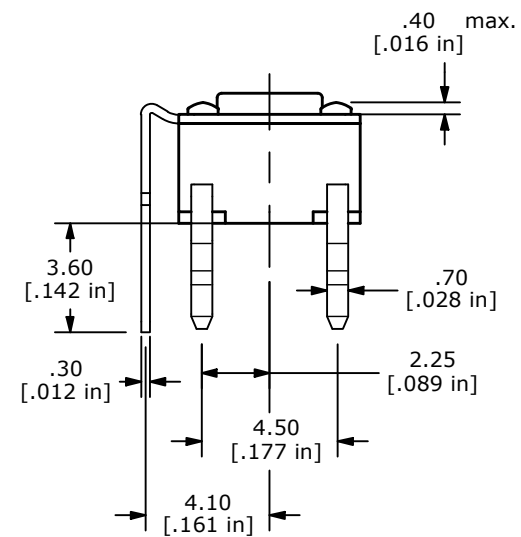
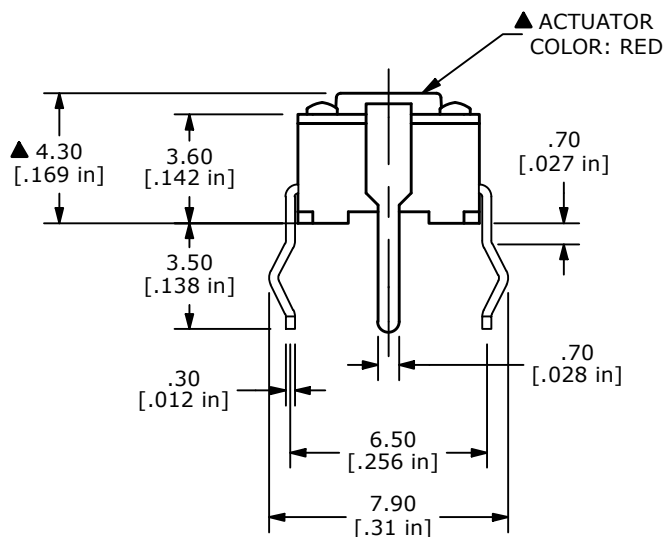

C	24510	CHANGE OPERATING TEMPERATURE	10/6/20	JM
B	17636	Added Notes 12, 13	9/13/07	BF
A	11903	RELEASED FOR PRODUCTION	2/5/02	CJB
REV	PCR NO	DESCRIPTION	DATE	BY

THE INFORMATION CONTAINED IN THIS DOCUMENT IS PROPRIETARY
TO E-SWITCH AND IS NOT TO BE COPIED OR TRANSFERRED



E-SWITCH®

TITLE	TLE1105F250Q
-------	--------------

SCALE
4:1

DATE 9/13/2007

DR	BF
----	----

DWG	P010110
-----	---------

REV
C