

| SWITCH | WIRE | LENGTH |
|----------|--------------------------------|-----------------|
| SW1-1 | WIRE, 24AWG AWM UL1015, BLUE | 300.0 [11.8 in] |
| SW1-2 | WIRE, 24AWG AWM UL1015, PURPLE | 300.0 [11.8 in] |
| SW1-3 | WIRE, 24AWG AWM UL1015, GREEN | 300.0 [11.8 in] |
| SW1-4 | WIRE, 24AWG AWM UL1015, WHITE | 300.0 [11.8 in] |
| SW1-5 | WIRE, 24AWG AWM UL1015, ORANGE | 300.0 [11.8 in] |
| SW1-6 | WIRE, 24AWG AWM UL1015, YELLOW | 300.0 [11.8 in] |
| SW1- (-) | WIRE, 24AWG AWM UL1015, BLACK | 300.0 [11.8 in] |
| SW1- (+) | WIRE, 24AWG AWM UL1015, RED | 300.0 [11.8 in] |

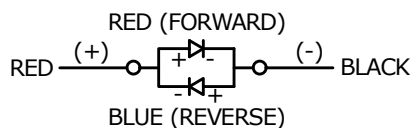

SCHEMATIC

ON - (ON) - DPDT ILLUMINATED
 () DENOTES MOMENTARY FUNCTION

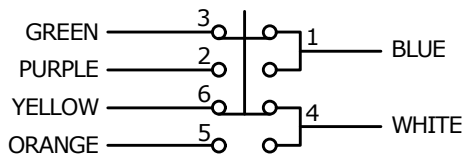
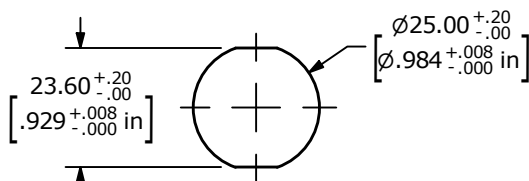

RECOMMENDED PANEL CUTOUT
 MAX. PANEL THICKNESS 10mm

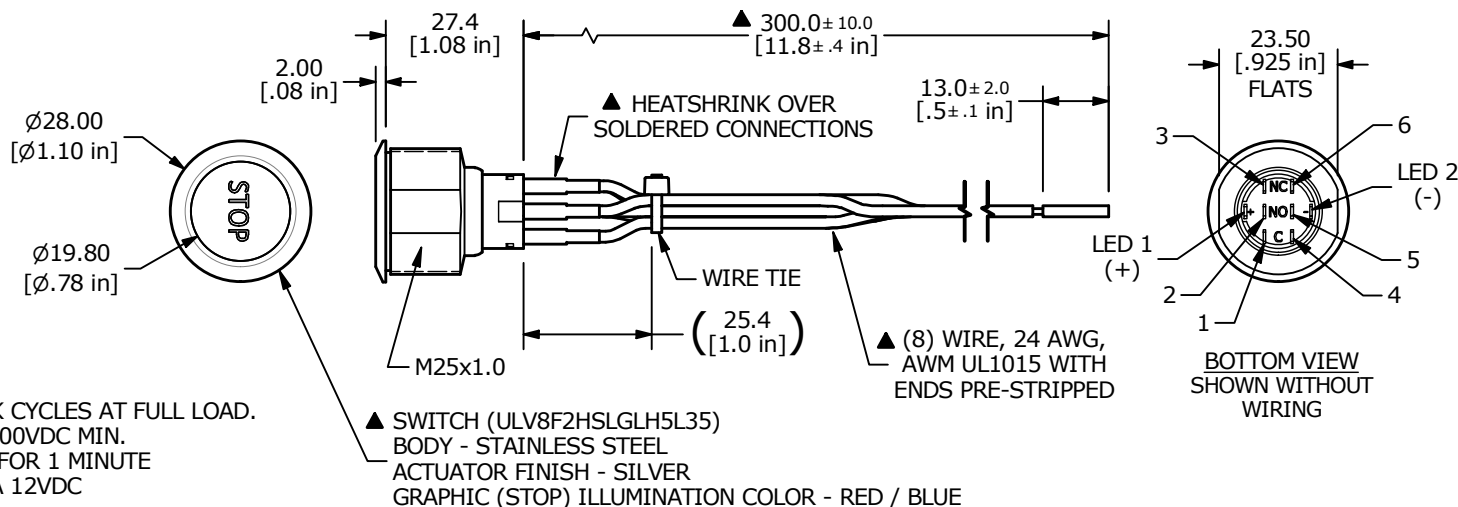
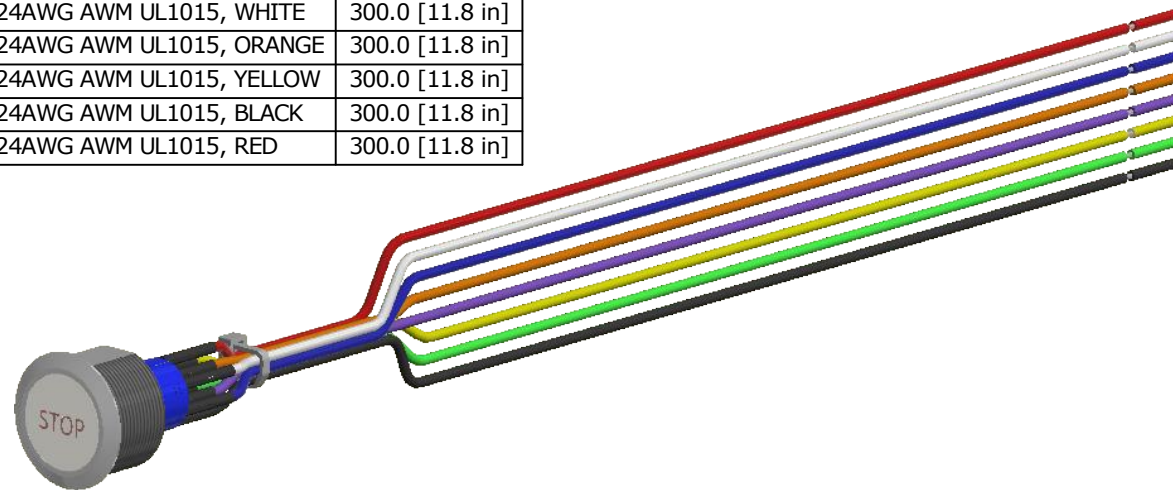

NOTES:

1. DIMENSIONS IN MM [INCH]
2. GENERAL TOLERANCE: X.X = ±0.4
X.XX = ±0.25
3. TERMINAL NUMBERS FOR REF ONLY
- ▲ 4. CONTACT MATERIAL: GOLD
5. RATING: 3A 250 VAC cUL
6. OPERATING TEMP.: -20°C to 55°C
- ▲ 7. LAMP VOLTAGE: 20mA 24V
8. TRAVEL: 3.2mm
9. ACTUATION FORCE: 3.5 ± 1.0 N
10. MOUNTING NUT TORQUE: 5-14 Nm
11. INGRESS PROTECTION: IP67, IK08
12. MECHANICAL LIFE: 1,000,000 CYCLES.
13. ELECTRIC LIFE: 50,000 MAKE-AND-BREAK CYCLES AT FULL LOAD.
14. INSULATION RESISTANCE: 1,000 MΩ @ 500VDC MIN.
15. DIELECTRIC STRENGTH: 2,000 VAC MIN. FOR 1 MINUTE
16. CONTACT RESISTANCE: 50mΩ MAX. @ 1A 12VDC
17. ▲ DENOTES CRITICAL PARAMETER.
18. ALL MATERIAL SHALL BE ROHS COMPLIANT
- ▲ 19. SUPPLIED HARDWARE: O-RING AND HEXNUT
- ▲ 20. USE P/N'S DESIGNATED OR ENGINEERING APPROVED EQUIVALENTS.

| REV | ECO NO | DESCRIPTION | DATE | BY |
|-----|------------|-------------|----------|----|
| A | ECO-101355 | Release | 10/28/22 | MW |



OBJECT ID
100122964

| | | | | | | |
|---------------------------|--|--------------|--------------------|----------|----------------|----------|
| TITLE ULV8FWHSLGLH5L35 | | SCALE 2:3 | DATE 10/27/2022 | DR MW | DWG T980506 | REV A |
|---------------------------|--|--------------|--------------------|----------|----------------|----------|