

# TL2285 SERIES PUSHBUTTON SWITCH

ANTI-VANDAL SWITCHES  
 DETECTOR SWITCHES  
 DIP SWITCHES  
 KEYLOCK SWITCHES  
 NAVIGATION SWITCHES  
**PUSHBUTTON SWITCHES**  
 ROCKER SWITCHES  
 ROTARY SWITCHES  
 SLIDE SWITCHES  
 SNAP ACTION SWITCHES  
 TACTILE SWITCHES  
 TOGGLE SWITCHES  
 CAP OPTIONS

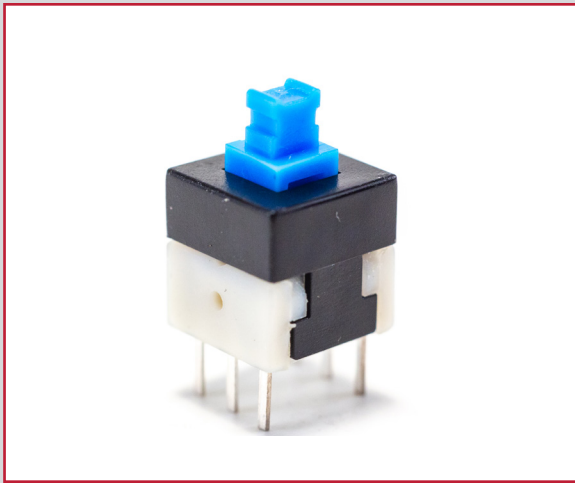

## APPLICATIONS / MARKETS



Audio / Visual



Consumer Electronics



Vending Machines

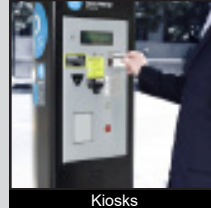

Kiosks



Instrumentation



Medical Equipment

**RoHS**

## SPECIFICATIONS

**Electrical Rating:** 100mA, 30VDC  
**Electrical Life:** 10,000 Cycles  
**Contact Resistance:** 100mΩ Max. Initial  
**Insulation Resistance:** 100MΩ Min.  
**Dielectric Strength:** 500VAC  
**Operating Temperature:** -20°C to 70°C  
**Actuation Force:** 160 ±80gf  
**Circuit:** DPDT; latching or momentary  
**Travel:** 2.5mm Full; 1.5mm to Lock Position  
**Timing:** Non-Shorting (BBM)

## FEATURES & BENEFITS

- Through hole mounting design
- PC Pin termination
- DPDT circuit; latching or momentary function
- Plunger actuator; long travel
- Non-shorting (BBM)

## PART NUMBER CONFIGURATOR

Series

TL2285

Mechanical Configuration

EE - Latching  
 OA - Momentary

*Specifications subject to change without notice 1.1.2026*



**E-SWITCH®**

www.e-switch.com

800.867.2717

1

# TL2285 SERIES PUSHBUTTON SWITCH

## BODY DIMENSIONS

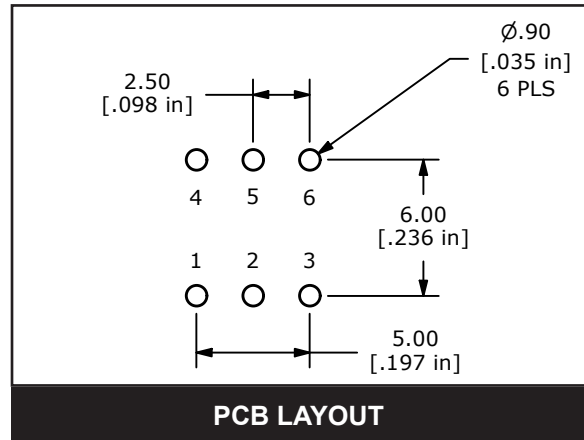
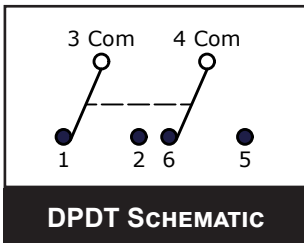
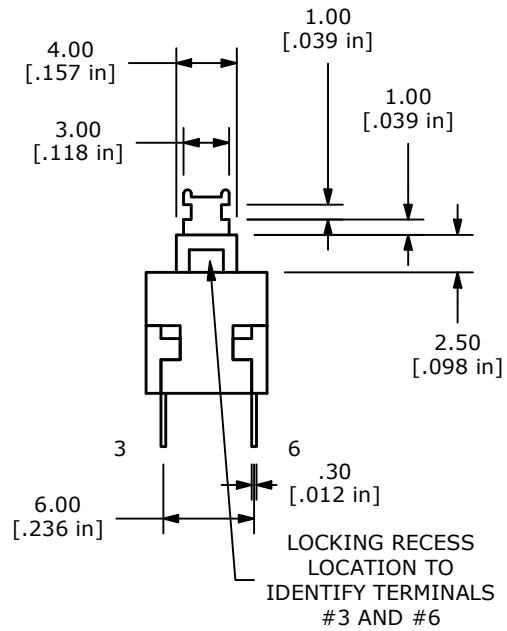
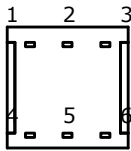
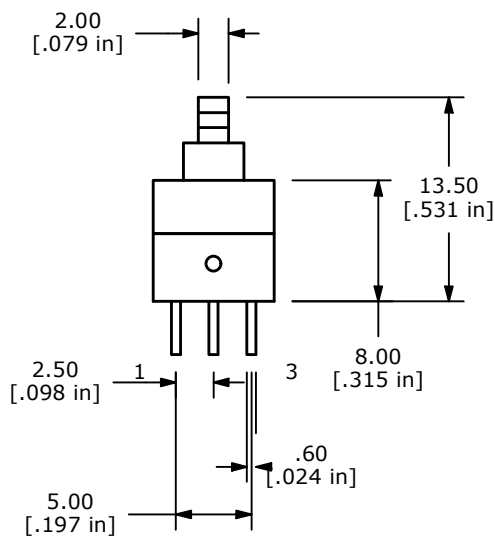
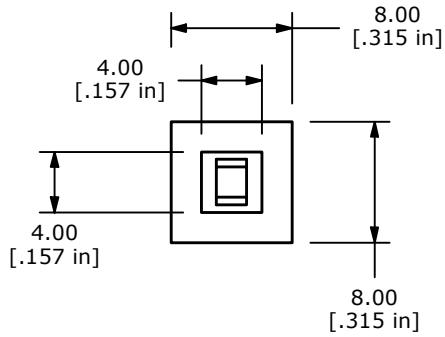

ANTI-VANDAL SWITCHES  
DETECTOR SWITCHES  
DIP SWITCHES  
KEYLOCK SWITCHES  
NAVIGATION SWITCHES  
**PUSHBUTTON SWITCHES**  
ROCKER SWITCHES  
ROTARY SWITCHES  
SLIDE SWITCHES  
SNAP ACTION SWITCHES  
TACTILE SWITCHES  
TOGGLE SWITCHES  
CAP OPTIONS