

TL6300 SERIES TACT SWITCH

ANTI-VANDAL SWITCHES
 DETECTOR SWITCHES
 DIP SWITCHES
 KEYLOCK SWITCHES
 NAVIGATION SWITCHES
 PUSHBUTTON SWITCHES
 ROCKER SWITCHES
 ROTARY SWITCHES
 SLIDE SWITCHES
 SNAP ACTION SWITCHES
TACTILE SWITCHES
 TOGGLE SWITCHES
 CAP OPTIONS

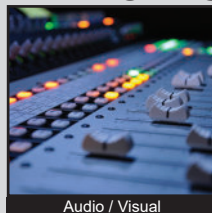

APPLICATIONS / MARKETS



Audio / Visual

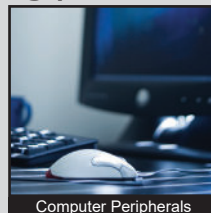

Computer Peripherals



Consumer Electronics

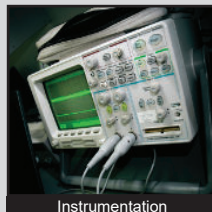

Instrumentation

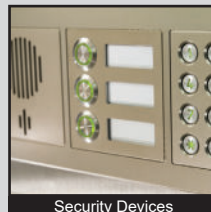

Security Devices

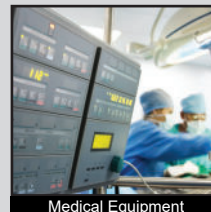

Medical Equipment

RoHS

SPECIFICATIONS

Contact Arrangement: SPST
Contact Rating: 50mA @ 12VDC
Contact Resistance: 100mΩ Initial
Insulation Resistance: 100 MΩ @ 100 VDC
Dielectric Strength: 250 VAC
Electrical Life: 10,000,000 cycles
Operating Temperature: -40°C to 105°C
Storage Temperature: -40°C to 105°C
Travel: 0.3mm
Actuation Force: 130gf, 260gf
Moisture Protection: IP67
Bounce: 10m Second Max.

FEATURES & BENEFITS

- 10,000,000 cycle life expectancy
- IP67 ingress protection
- PCB Mount
- Sharp tactile response
- Actuator height options
- Actuation force options

PART NUMBER CONFIGURATOR

Series

TL6300

Actuator

A - 7.30mm
B - 4.30mm

Actuation Force

F260 - 260 gf
F130 - 130 gf

Contact Material

Q - Silver

Terminal

P - Thru Hole PCB

Specifications subject to change without notice 9.3.2024



E-SWITCH®

www.e-switch.com

800.867.2717

1

TL6300 SERIES TACT SWITCH

BODY DIMENSIONS

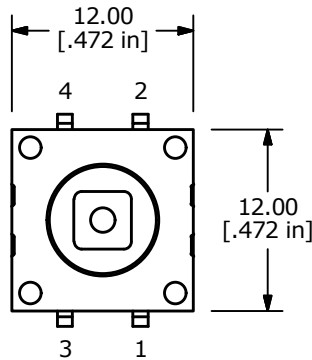
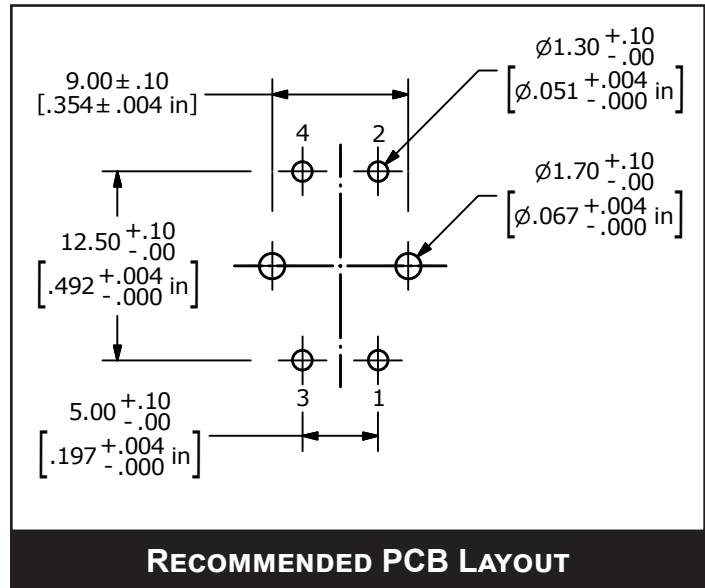
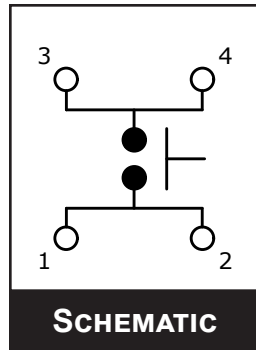

ACTUATOR	"L"
A	7.30
B	4.30

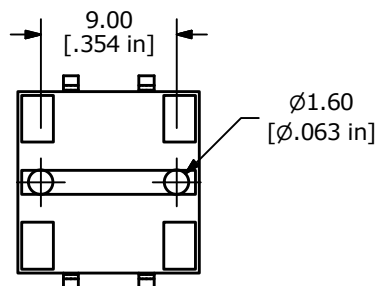
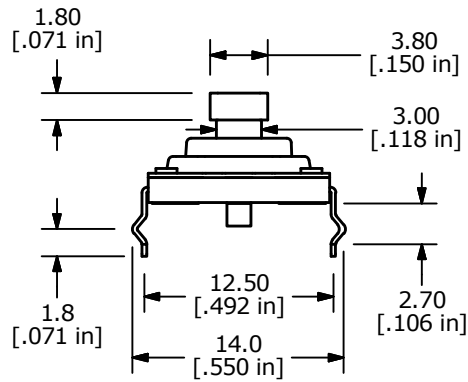
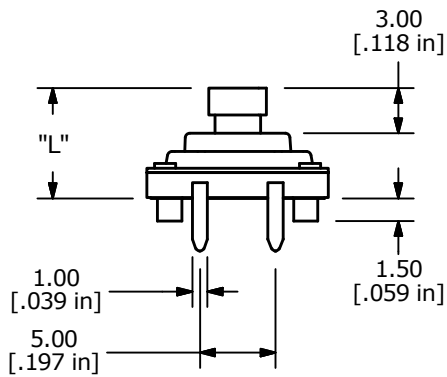

ANTI-VANDAL SWITCHES
 DETECTOR SWITCHES
 DIP SWITCHES
 KEYLOCK SWITCHES
 NAVIGATION SWITCHES
 PUSHBUTTON SWITCHES
 ROCKER SWITCHES
 ROTARY SWITCHES
 SLIDE SWITCHES
 SNAP ACTION SWITCHES
 TACTILE SWITCHES
 TOGGLE SWITCHES
 CAP OPTIONS